

PRE INSTALLATION GUIDE

FÖRINSTALLATIONSGUIDE
ANLEITUNG VOR DER INSTALLATION
預安裝指南

FOR

TopBrewer

PRO



Scanomat
Download Center



Scanomat
Connection Diagram



Scanomat
Architect Pack
(2D/3D Files)

For TopBrewer Pro
Version: 4.0
01-01-2020

CONTENTS

| | |
|---|---|
| » Introduction | 3 |
| » Product Matrix: Choose your setup | 4 |
| » Products Overview | 5 |
| » Space requirements: Basic Installation | 6 |
| » Space requirements: Extended Installation | 7 |

CARPENTER & VENTILATION 8

| | |
|---|----|
| » Basic Installations | |
| » Example 1 - Pro Fridge A2 | 9 |
| » Example 2 - Pro Fridge A3 | 10 |
| » Example 3 - Duct rediverted | 11 |
| » Extended / Special Installations | |
| » Example 1 - with cold water | 12 |
| » Example 2 - with two Pro | 13 |
| » Example 3 - behind a wall | 14 |
| » Faucet and Drip tray | 15 |
| » Topmounted iPad holder | 16 |
| » Boxit Alu iPad Holder | 17 |
| » Drip trays | 18 |

ELECTRICAL 19

| | |
|---------------------------|----|
| » Electrical Requirements | 20 |
|---------------------------|----|

PLUMBING 21

| | |
|-------------------------------|----|
| » Plumbing - adjacent cabinet | 22 |
| » Plumbing - same cabinet | 23 |

Introduction

The operation of a TopBrewer Pro coffee system.

The TopBrewer Pro consists of a main unit, the coffee machine, the "swan neck" or tap that is installed through the tabletop and is height adjustable through the mounting bracket, a drained drip tray and a ventilation kit for the toe kick base. Additionally we offer optional accessories that are installed along side of the TopBrewer. These accessories include our extensive lineup of fridges, coolers and racks (overview on next page) that expands the machines capabilities to include milk, chocolate and ice water.

The TopBrewer is connected to the cold water supply and water is heated in professional flashheaters, meaning on demand. This works by water flowing through two 2,3kW aluminum coils when a drinks is ordered and a separate steam-coil producing steam for milk. The total heating capacity of the TopBrewer is thus 6,9 kW and it should be preferably connected to 400V, 3 phase, 16 amp (3-phase version) or 208-240V, single phase, 30 amp (single phase version) for the machine to perform to it's full potential. If only 208-240V, single phase, 10 amps is available, the machine can be re-programmed to run on a priority heating diverting power to the heating source needing it the most.

When ordering a milk drink, milk is pumped from the fridge (the pump is placed inside the fridge for sanitary reasons), and once a delivery is done the machine finishes with pushing the remaining milk out with cold water and thus cleaning the entire tubing. The water does not enter the cup but is afterwards ejected into the drain via the double-valve inside the fridge.

All water shall be purified using TopBrewer certified filtration. We require that the main inlet is filtered through a filter with a bypass so that the water reaches 4 dH°. A second filter with 0% bypass is used to completely remove lime/scale from the dedicated steamer inlet.

Installation, maintenance and warranty

The TopBrewer system can be installed in almost any location provided there is sufficient space for the machine as well as power, water supply and waste.

The TopBrewer must be placed with sufficient clearance so that it may slide out on its hinges. The fridge must be fitted so that the length of the tubes does not exceed 1,5 mm . It can be installed in an adjacent cabinet provided it maintains such maximum length. Accessories such as the Scanomat Cooler 45 and the Chocolate rack must also stay within the same maximum distances to ensure proper dispense quality.

All equipment must be fitted so that they receive proper ventilation, with temperatures not exceeding 35°C, as this would harm components and void warranty.



Product Matrix

Choose your setup



Cabinet Layout

Configuration Choices

| | LESS THAN 590 MM DEPTH | ALLOWS FOR MORE THAN 590 MM DEPTH | HIDDEN OR BEHIND THE WALL |
|------------------------------|------------------------|-----------------------------------|---------------------------|
| WITH WATER | PAGE 12 | PAGE 12 | PAGE 13 |
| WITHOUT WATER | PAGE 10 | PAGE 9 | PAGE 13 |
| WITH HOT CHOCOLATE | N/A | PAGE 9 | PAGE 13 |
| WITH WATER AND HOT CHOCOLATE | PAGE 12 | PAGE 12 | PAGE 13 |



Products Overview

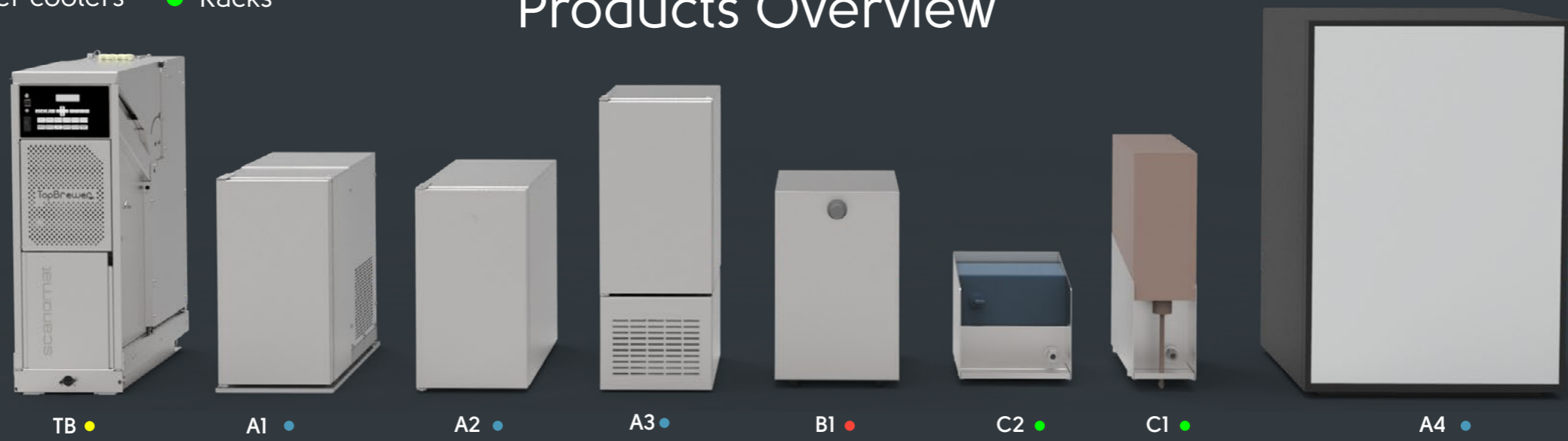

* OPTIONALLY WITH CO₂

| UNIT DETAILS | TopBrewer Pro | ICE-Bank (A1)* | Pro-fridge (A2) | Pro-fridge Tall (A3) | Cooler 45 (B1)* | Pro-Fridge BiB (A4) | Slimrack (C1) | Chocolate rack (C2) |
|---------------------------------|--|--|--|----------------------|--|--|----------------------|---------------------|
| Installation Dimensions (WxDxH) | 224 x 560 x 667 mm | 236 x 569 x 428.5 mm | 231 x 600 x 430 mm | 231 x 438 x 600 mm | 255 x 464 x 404 mm | 520 x 560 x 760 mm | 129 x 428 x 476,5 mm | 230 x 323 x 237 mm |
| Packing Dimensions (WxDxH) | 320 x 660 x 790 mm | 246 x 579 x 488.5 mm | 300 x 615 x 490 mm | 241 x 443 x 660 mm | 265 x 483 x 464 mm | 530 x 575 x 820 mm | 139 x 443 x 536,5 mm | 240 x 338 x 297 mm |
| Weight, gross. | 60 kg | 25 kg | 20 kg | 20 kg | 22 kg | 31 kg | 9 kg | 8 kg |
| Weight, net. | 56 kg | 22 kg | 17 kg | 17 kg | 19 kg | 28 kg | 6 kg | 5 kg |
| Bean/Carton Capacity | 2 x 1.4 kg | Up to 4 l. | Up to 8 l. | Up to 8 l. | - | 3x 10 l. Bag-in-box (up to) | 10 l. Bag-in-box | 3 l. Bag-in-box |
| Throughput/hour | 180 cups | 25 L | - | - | 45L | - | - | - |
| Approvals | CE, ETL/UL, CB, NSF | | CE | CE, ETL/UL | CE, ETL/UL | CE, ETL/UL, NSF | CE, ETL/UL | CE |
| Power | EU, 6900 Watt | 220-240V, 30 amp, single phase OR 400V, 16 amp, 3-phase | 220-240V, 10 Amp. 3-pin plug point for each unit.v | | | 31V DC from TopBrewer | | |
| | EU, 2300 Watt | (Priority Heating) 220-240V, 10 amp, single phase | | | | | | |
| | Canada & USA | L6-30 twist lock plug (supply male/female connections) | | | | | | |
| | United Kingdom | 32 Amp - Commando fitting (supply male/female connections) 1 x 10 Amp single phase (Priority heating) | | | | | | |
| Water | Direct Water Connection, 3/4" type shutoff valve Water pressure: 200kPa (2 Bar) - 600 kPa (6 Bar) | | - | - | Direct Water Connection, 3/4" type shutoff valve Water pressure: 200kPa (2 Bar) - 600 kPa (6 Bar) | - | - | - |
| Filtration | TopBrewer water filters fitted in a location adjacent to the TopBrewer. See plumbing section. Dedicated steam filter required (Pure 50, 0% bypass) | | TopBrewer ActiveCoal 10.000, optional, purifies the water with active coal | - | - | TopBrewer ActiveCoal 10.000, optional, purifies the water with active coal technology. | - | - |
| Drainage | Waste U-pipe, ø40mm. Manifold/drain plug (included, see Plumbing section) is inserted and components are connected here. | | | | | | | |
| Ventilation | Duct Fan Ventilation required. Cooler produces a lot of heat, which needs to be able to exit as per installation instructions in Carpenter section | | | | | | | |

Space requirements

Basic Installation

CLEARANCE HEIGHT NEEDED
FOR INSTALLATION OF SWAN NECK
MIN 500 MM

A 700 MM CABINET RECOMMENDED
MIN. TOTAL WIDTH 595 MM

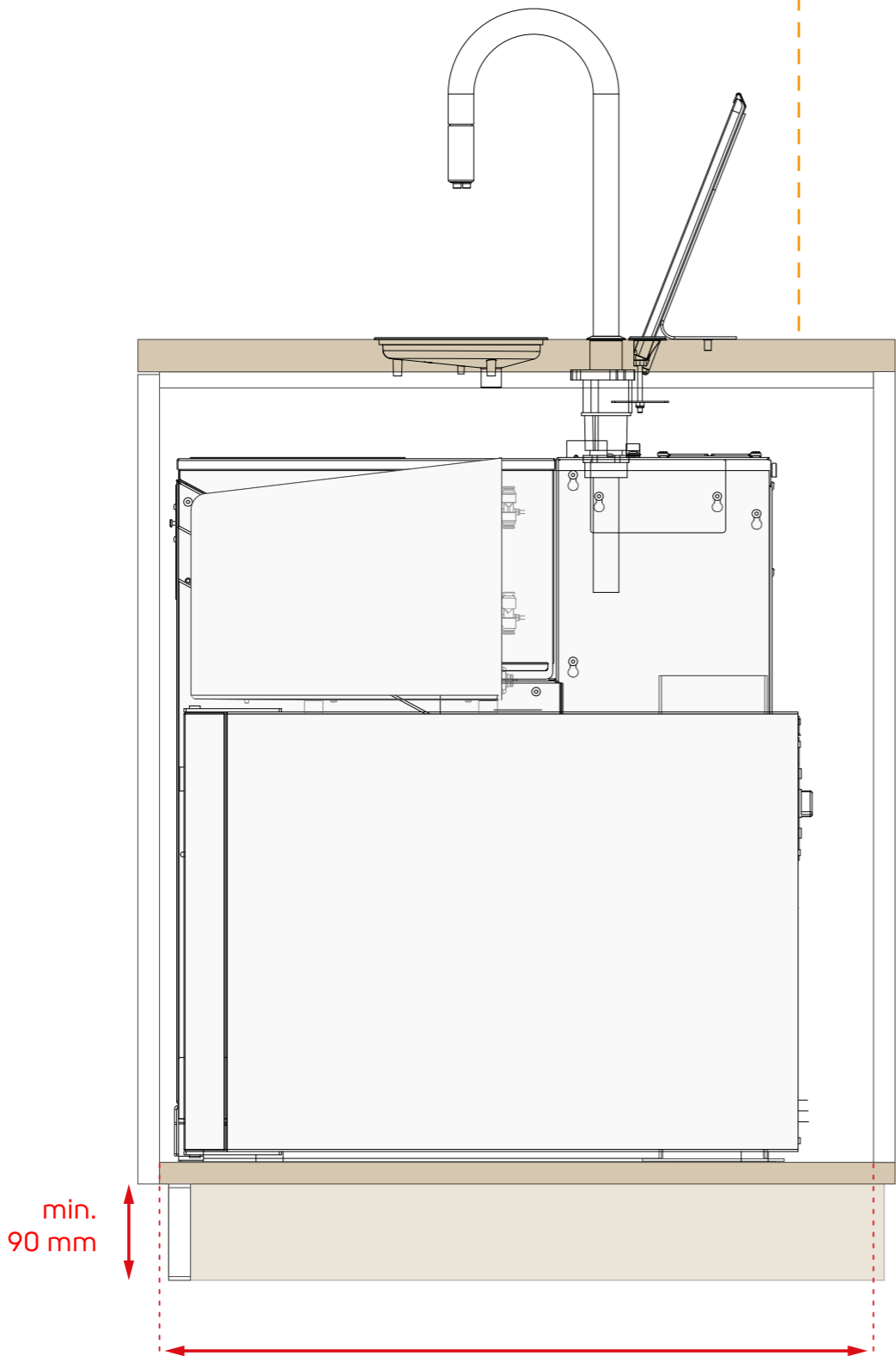

Recommended depth 650 mm
Minimum 600 mm

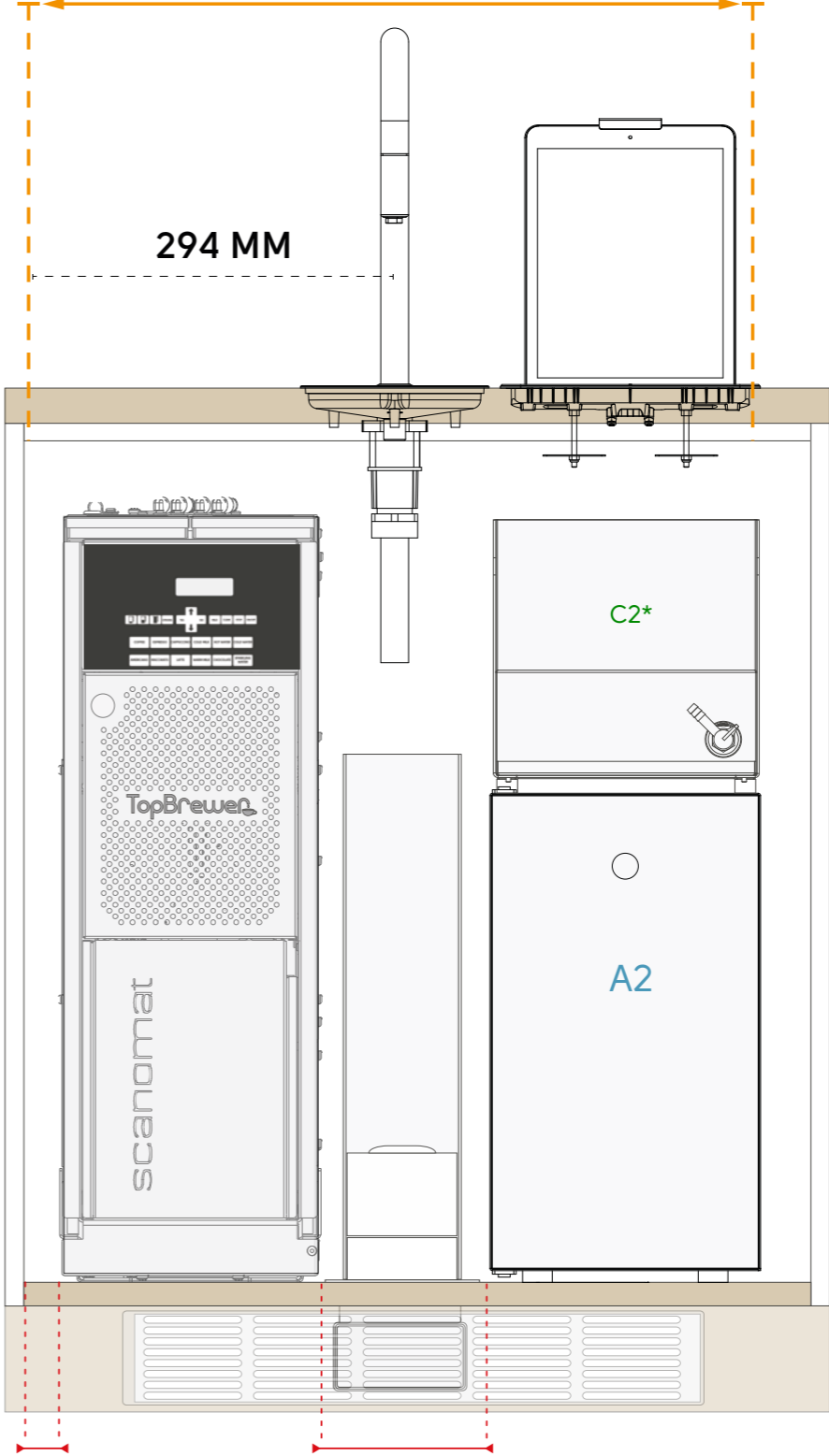

Always allow
min. 40 mm
clearance

Always allow
min. 60 mm
clearance

Space requirements

Extended Installation

CLEARANCE HEIGHT NEEDED FOR INSTALLATION OF SWAN NECK MIN 500 MM

A 700 MM CABINET RECOMMENDED
MIN. TOTAL WIDTH 580 MM

470 MM RECOMMENDED
MIN. TOTAL WIDTH 400 MM

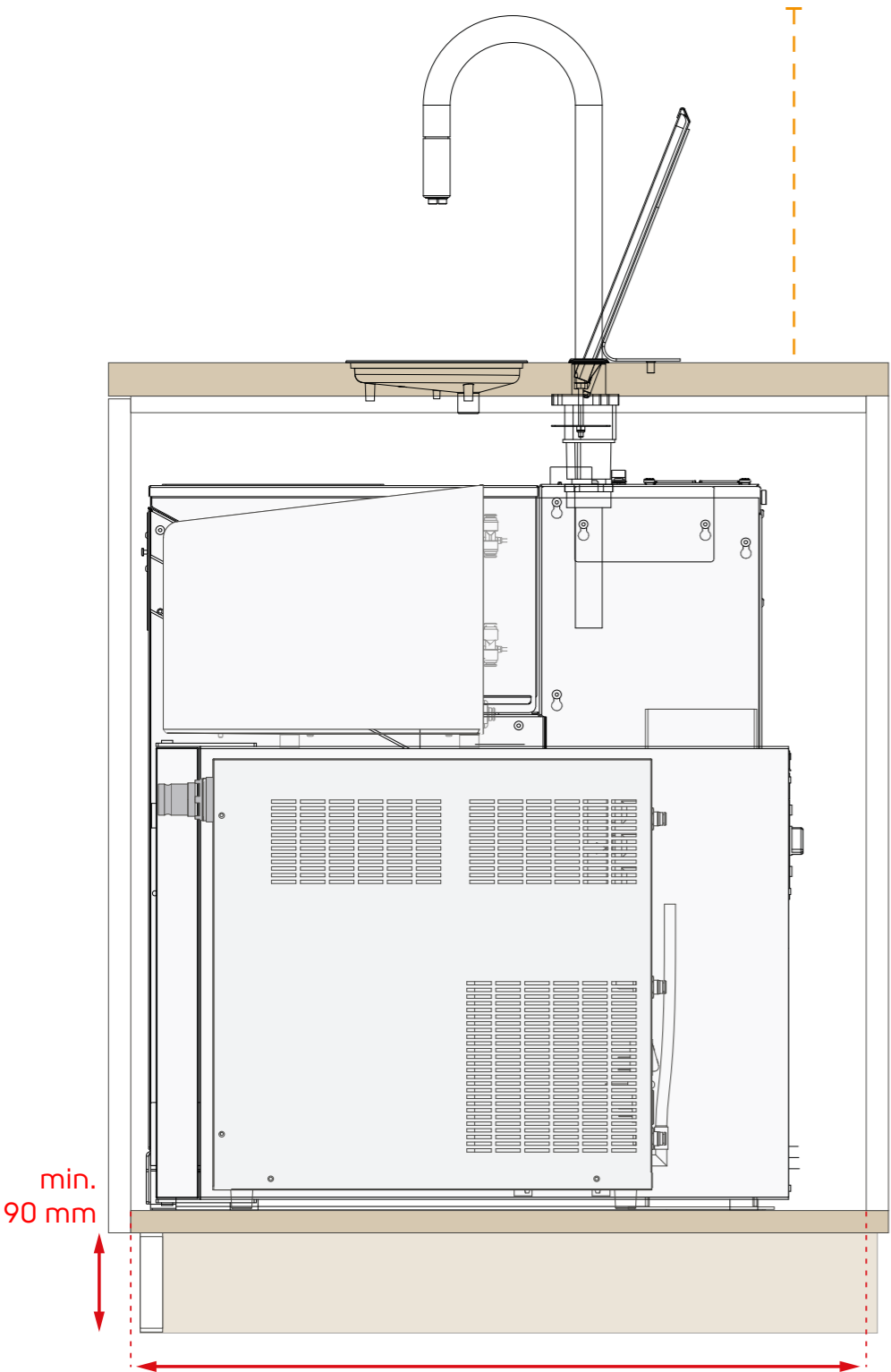

A1 : 569 mm
A2: 600 mm
A3: 534 mm
A4: 560 mm

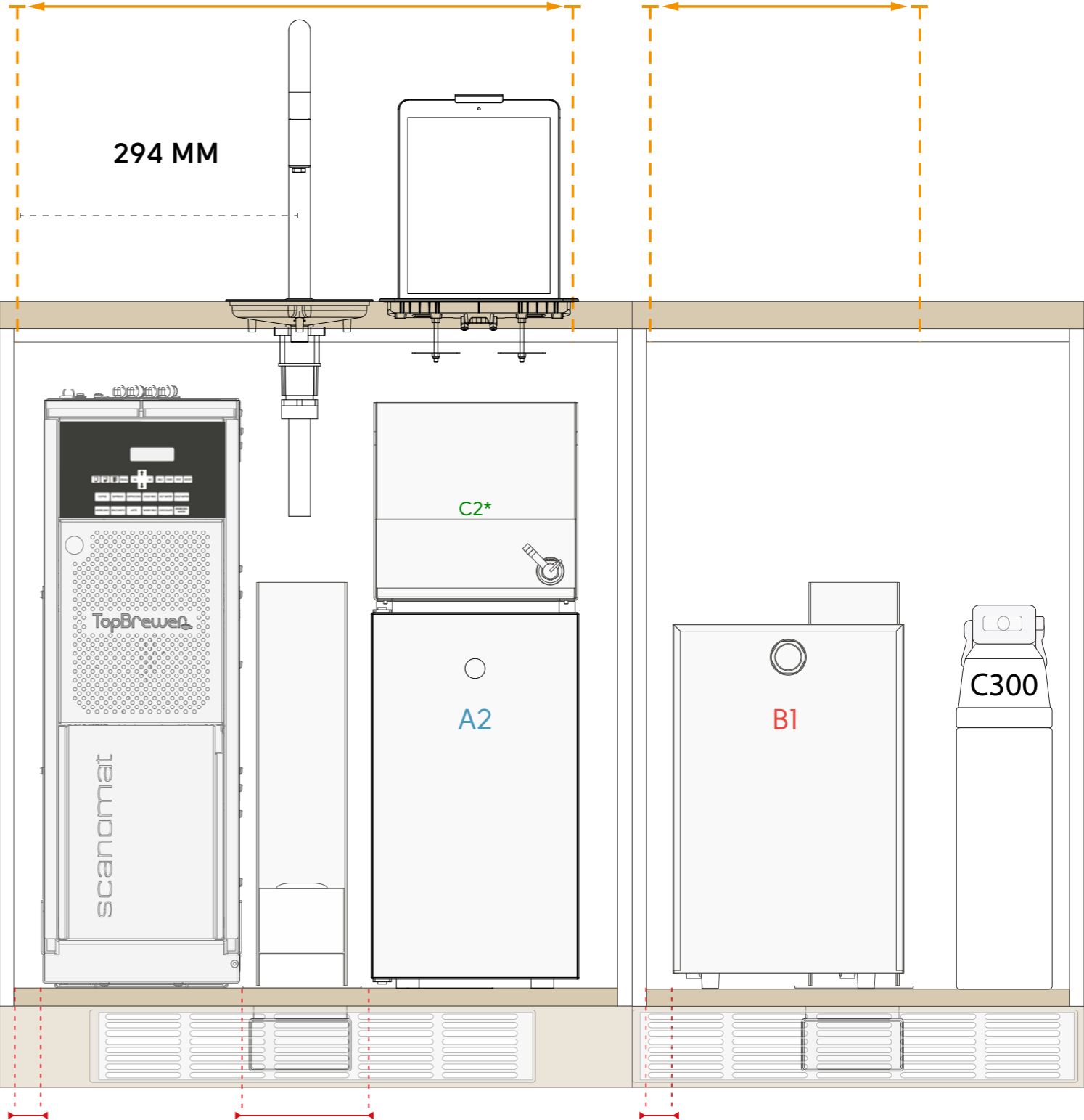

Always allow min. 40 mm clearance

Always allow min. 110 mm clearance

Always allow min. 40 mm clearance

CARPENTER

SNICKARE

ZIMMERMANN

木匠

Extended Installation

Adding Cooler 45 for ice water option

**AIR EXHAUST
SHOULD REMAIN
UNOBSTRUCTED**

Example 1

Using: TB + A2 or A3 + B1 + C2*

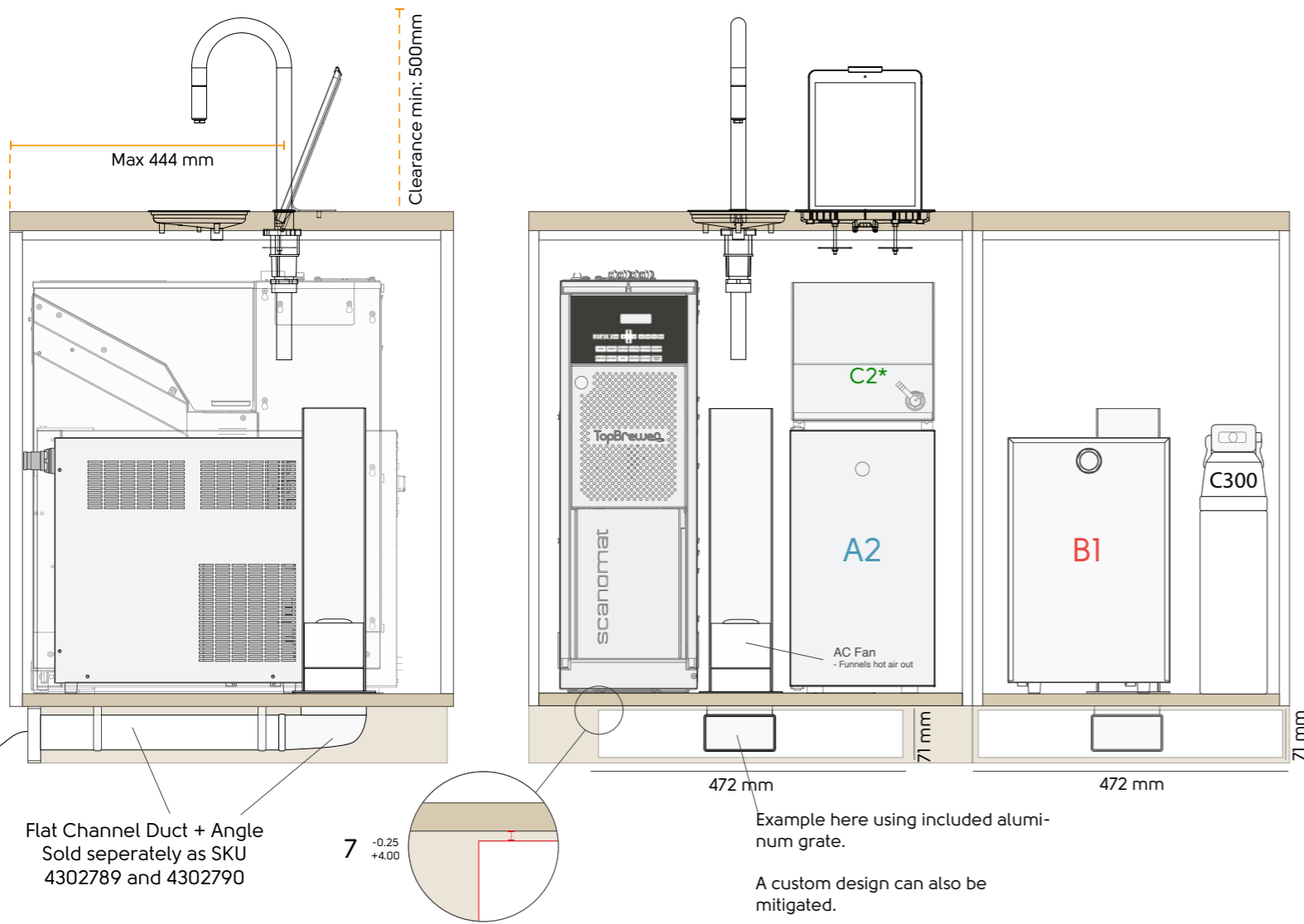

Side

Front

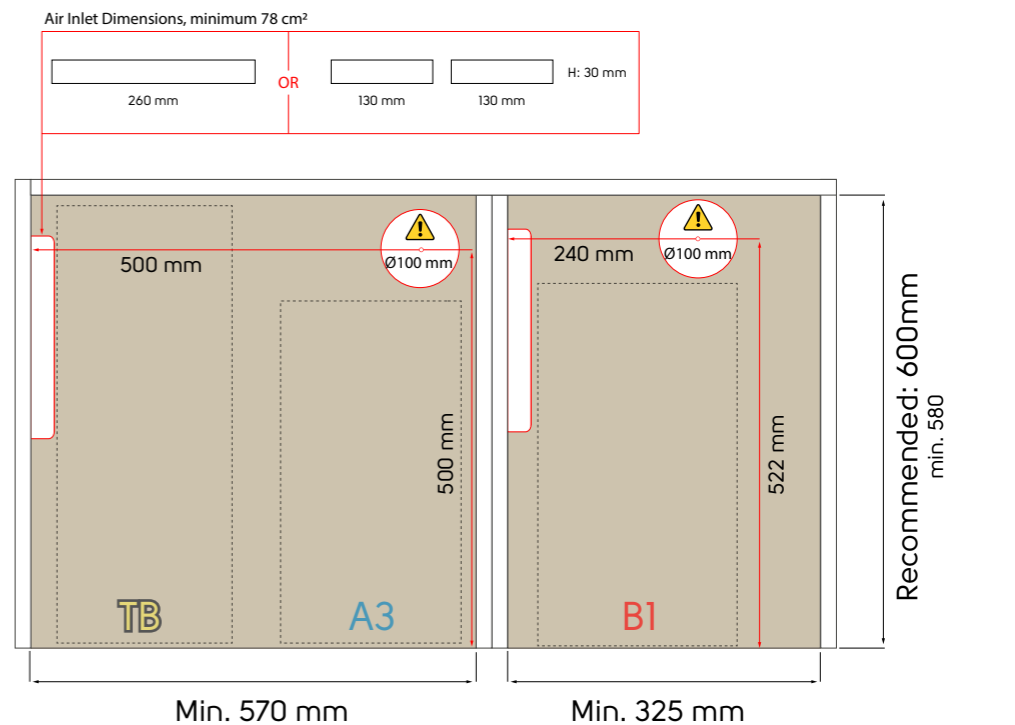
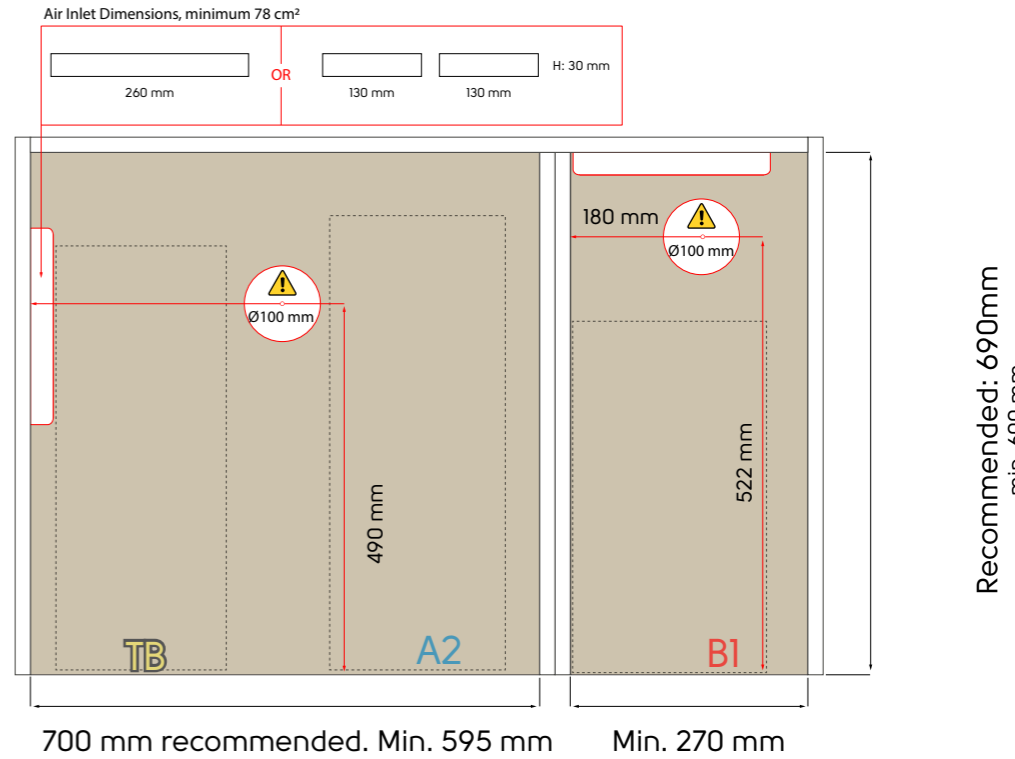

Top View

TopBrewer topmounted iPad Holder + Lock

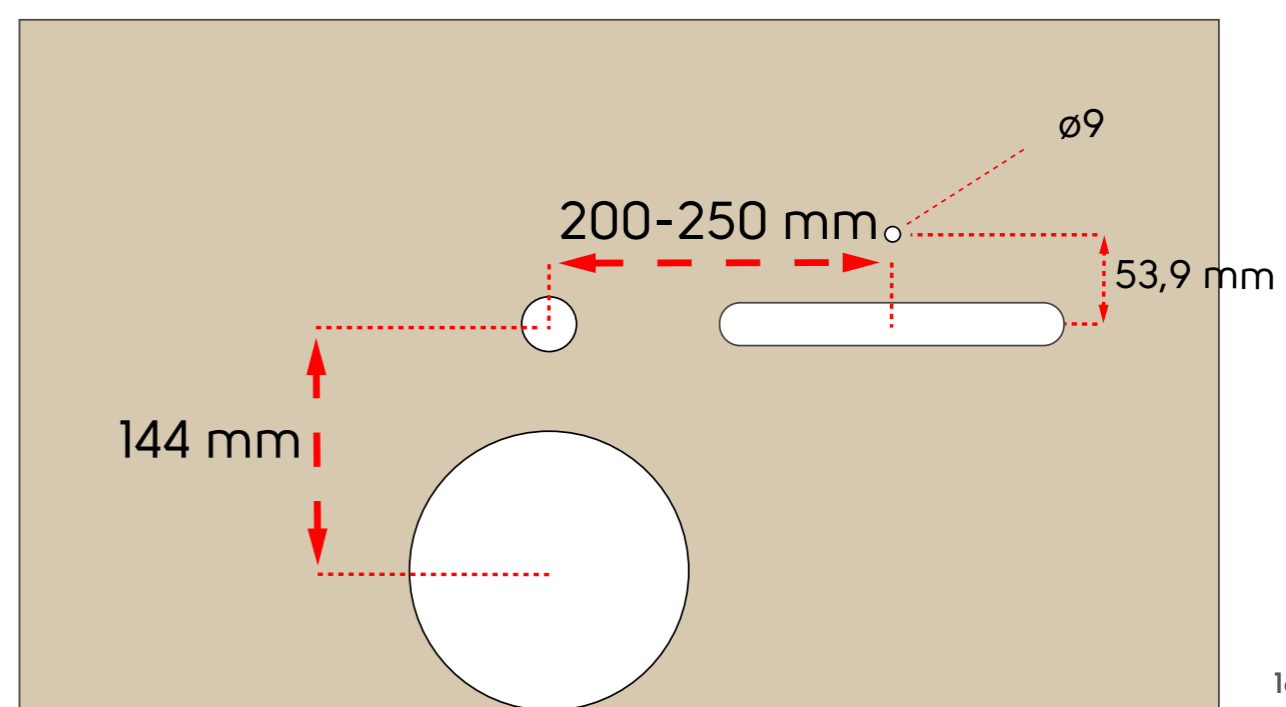
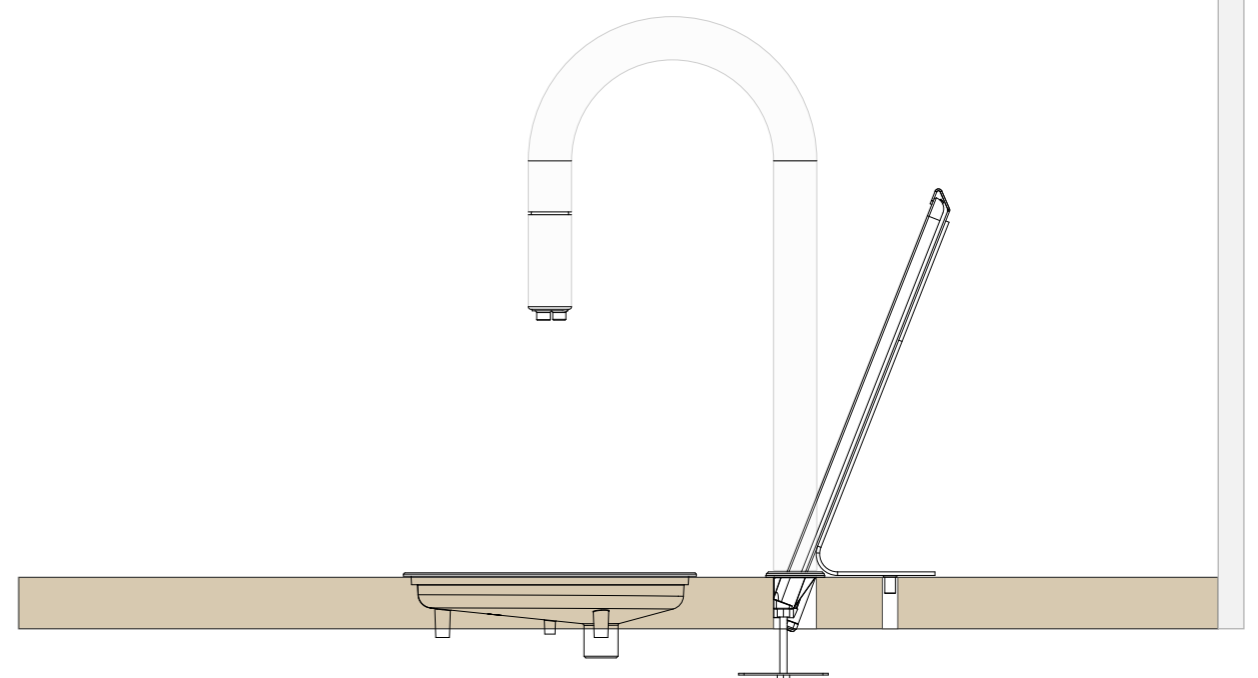
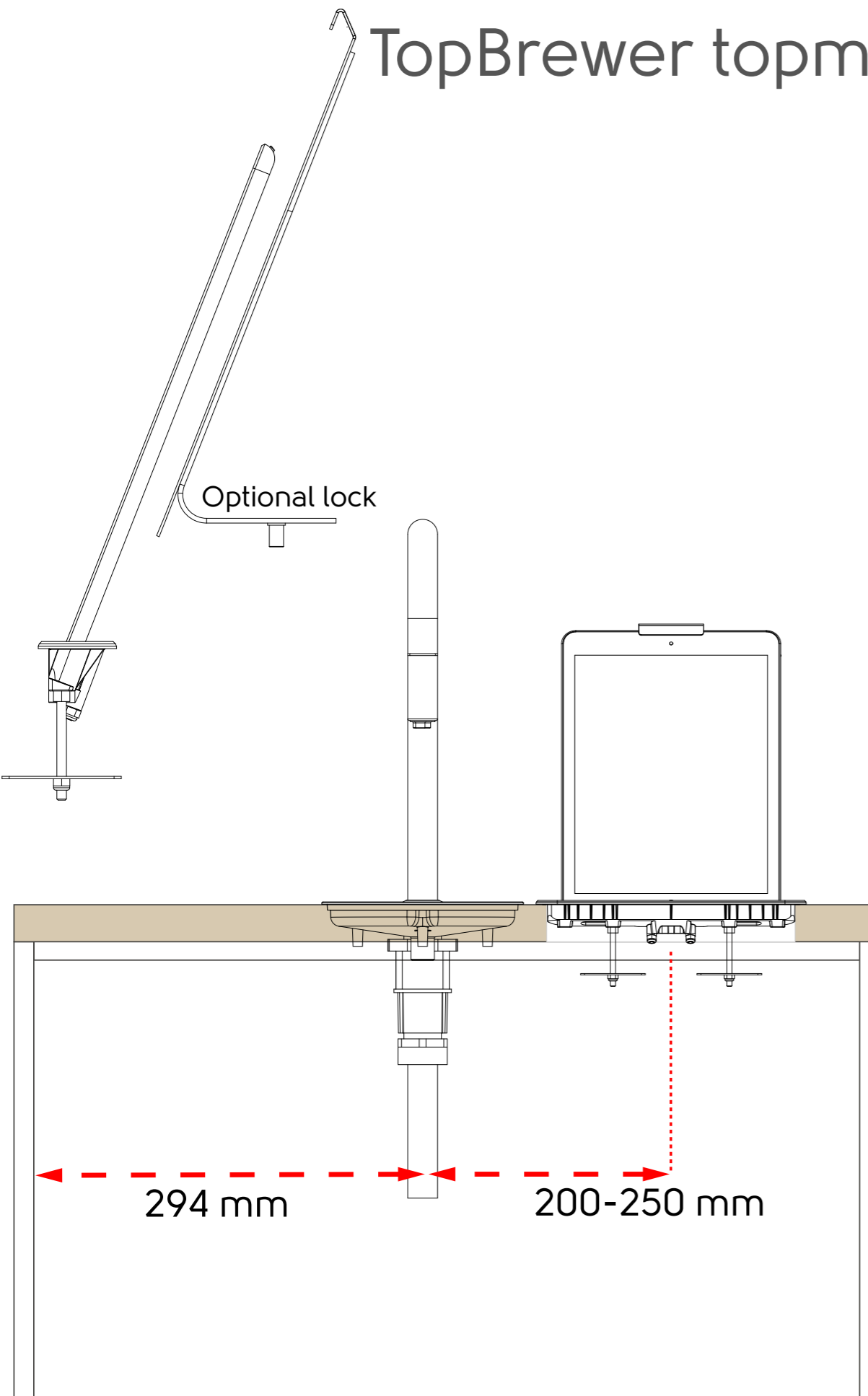

BOXIT (Table Mount or Wall-Mount options)

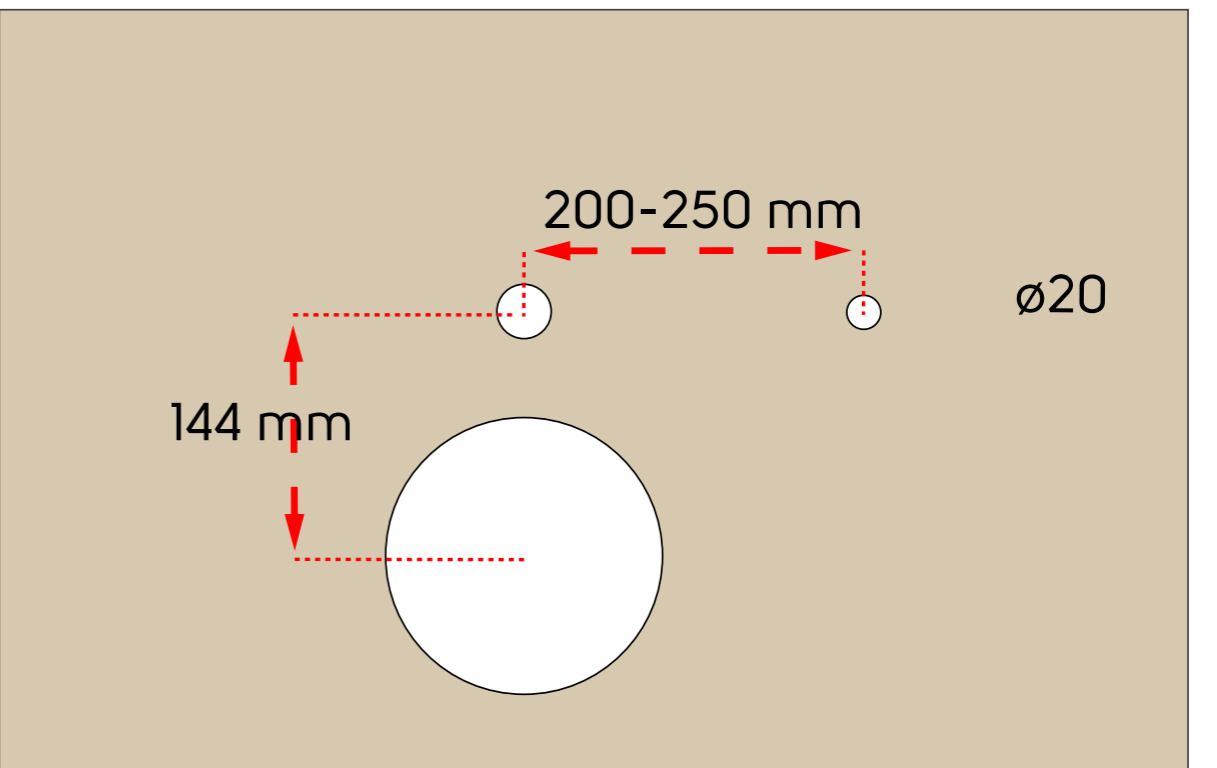
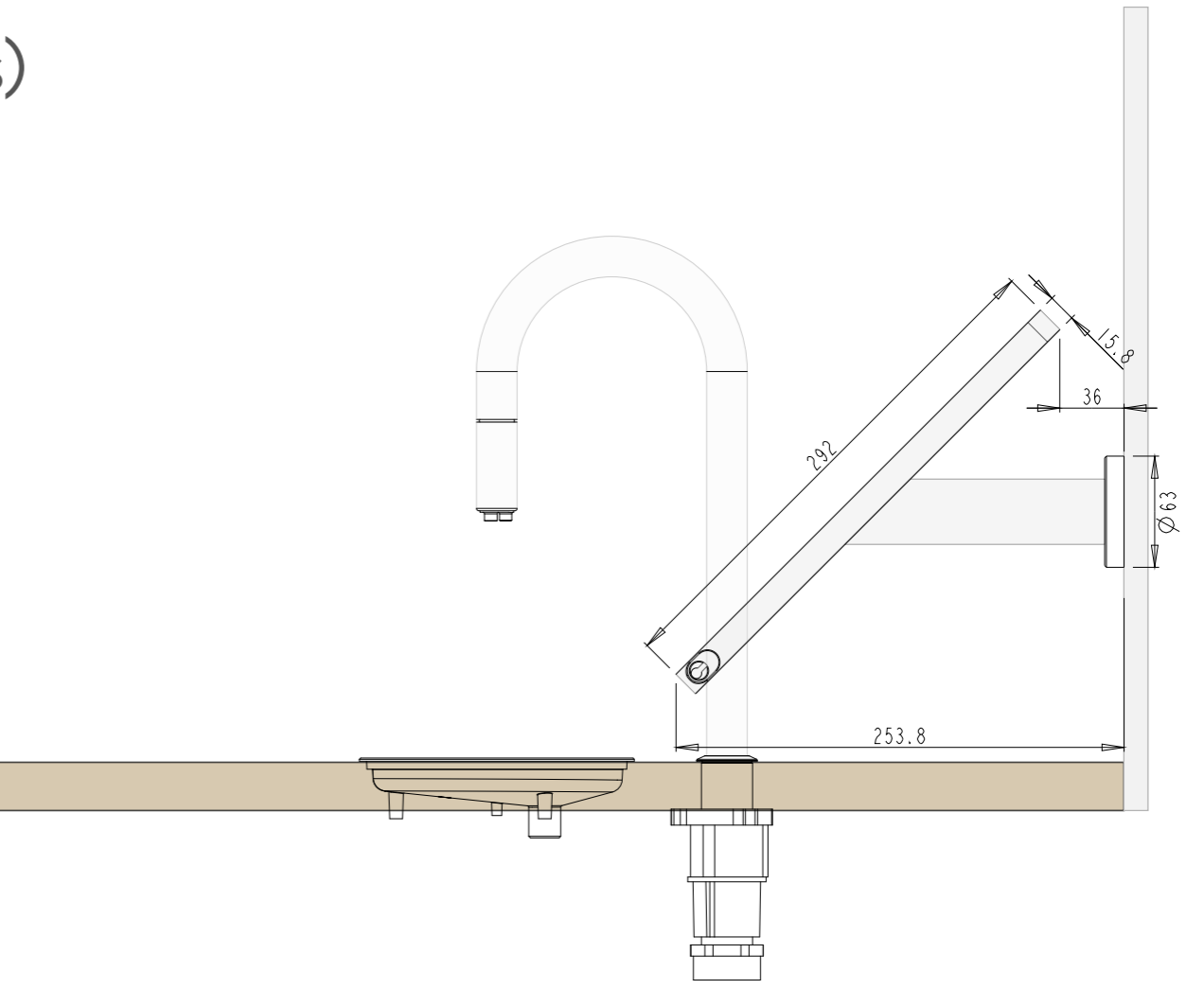
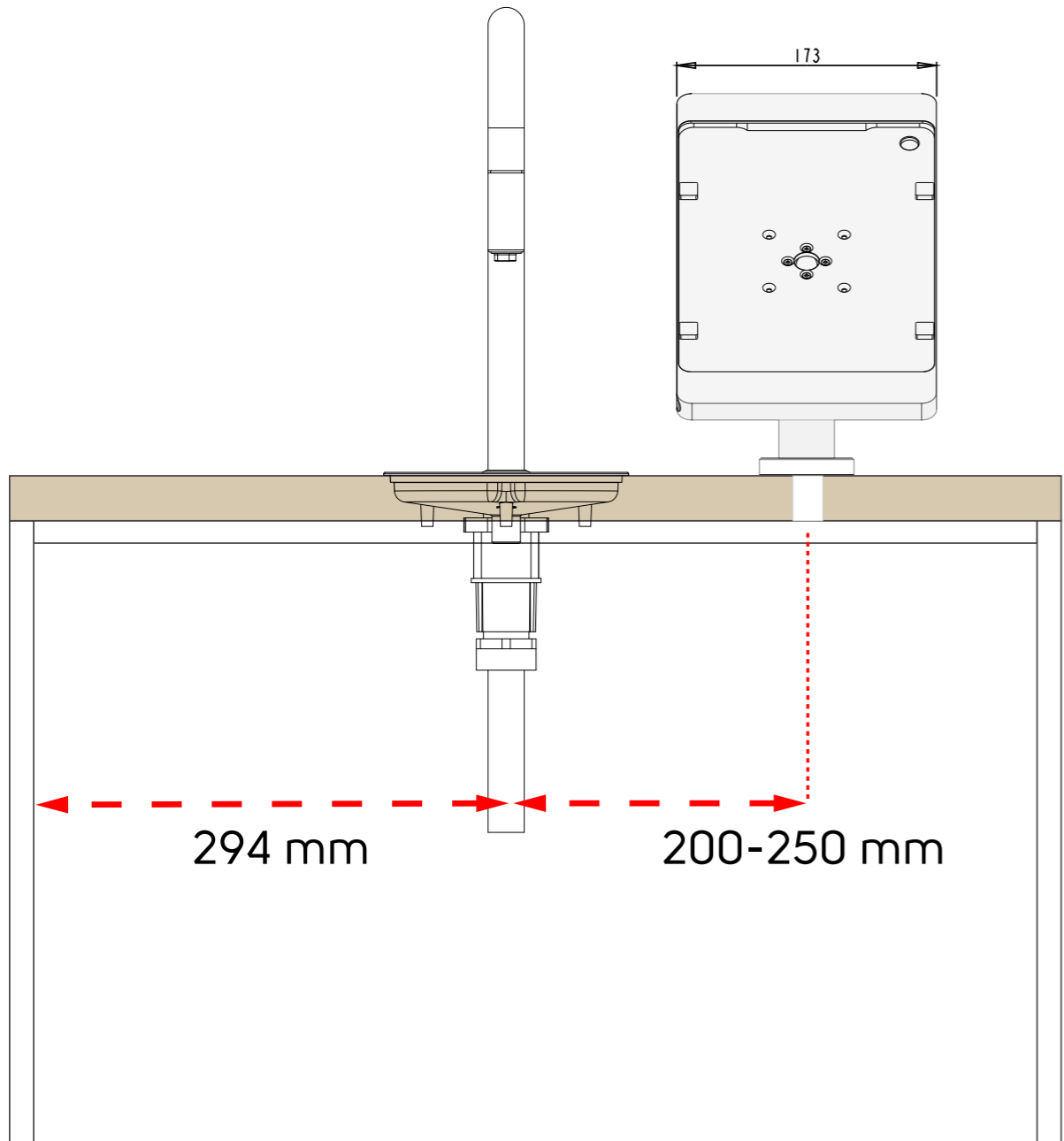

Cut out sheet - Swan neck + Driptray

NOTE that this driptray is best used for water resistant tabletops such as Granite, Marble or Corian. If wood, make sure pores are completely sealed.

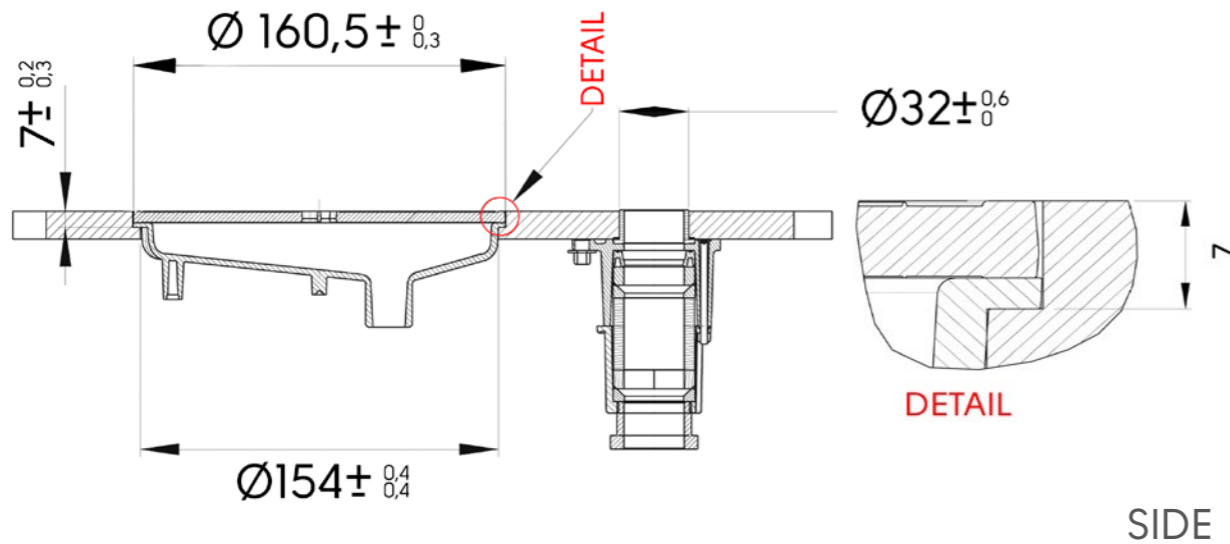

SIDE

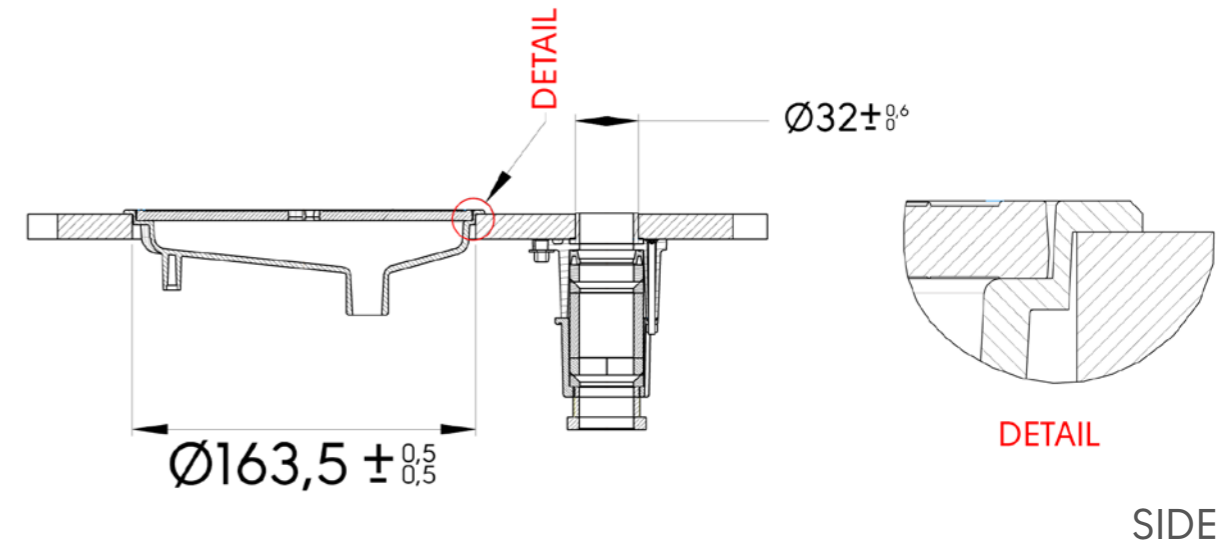

SIDE

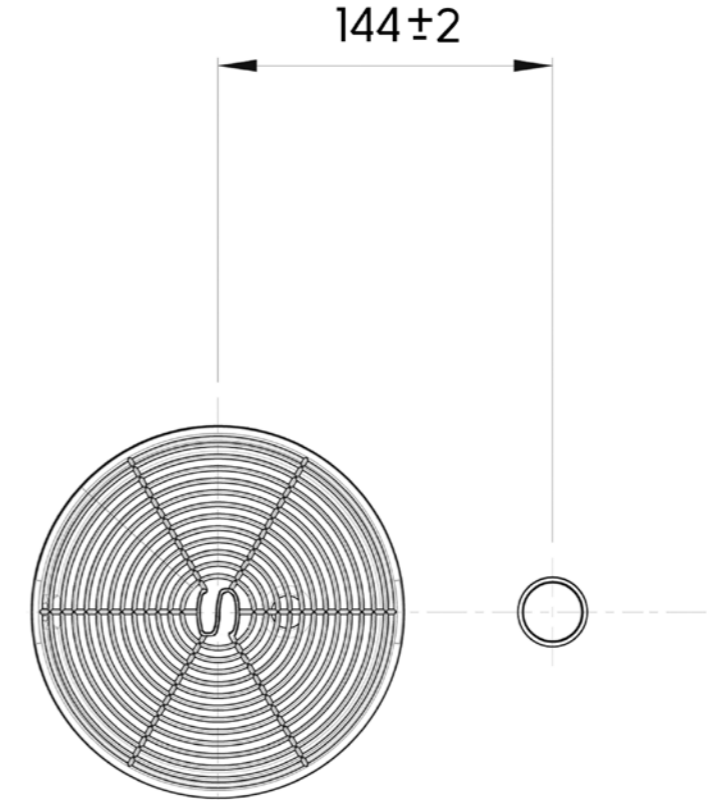
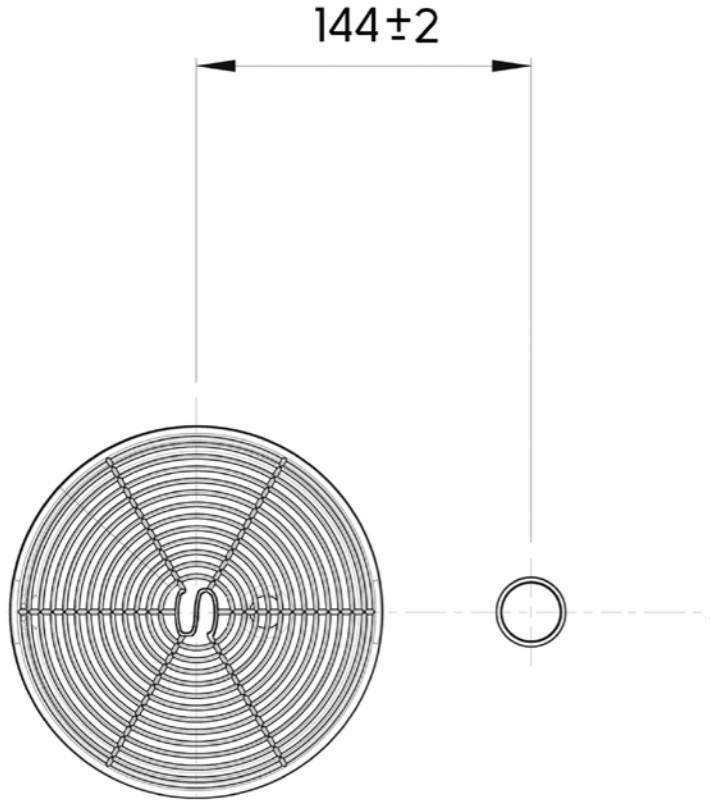

TOP

Flush mounted
- Countersunk -
Driptray 2006162 **1**

Top mounted
- With Lip -
Driptray 2006162_A **2**

ELECTRIC

ELEKTRISK

ELEKTRISCH

電的

Electrical Requirements

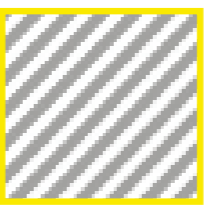
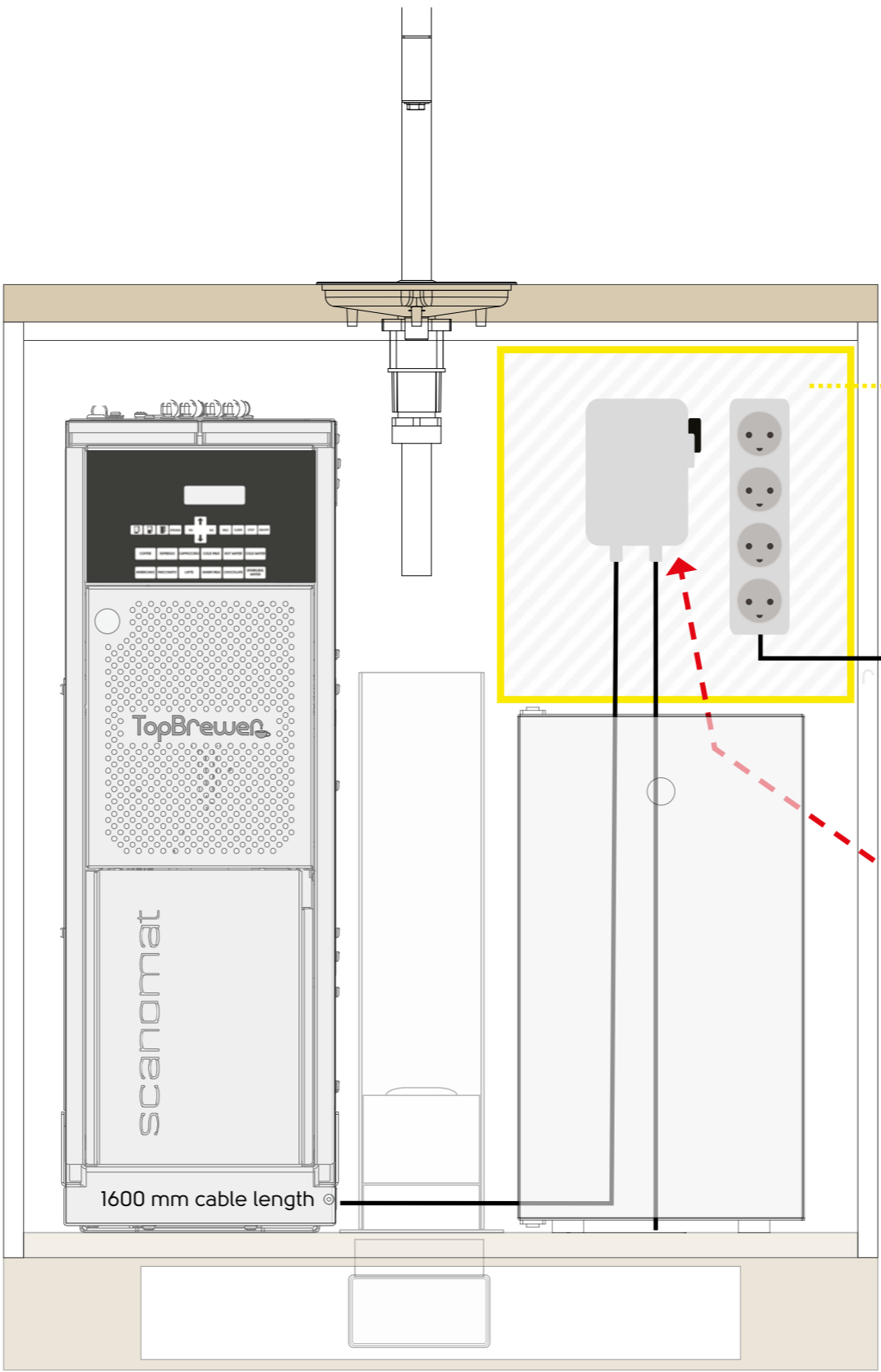
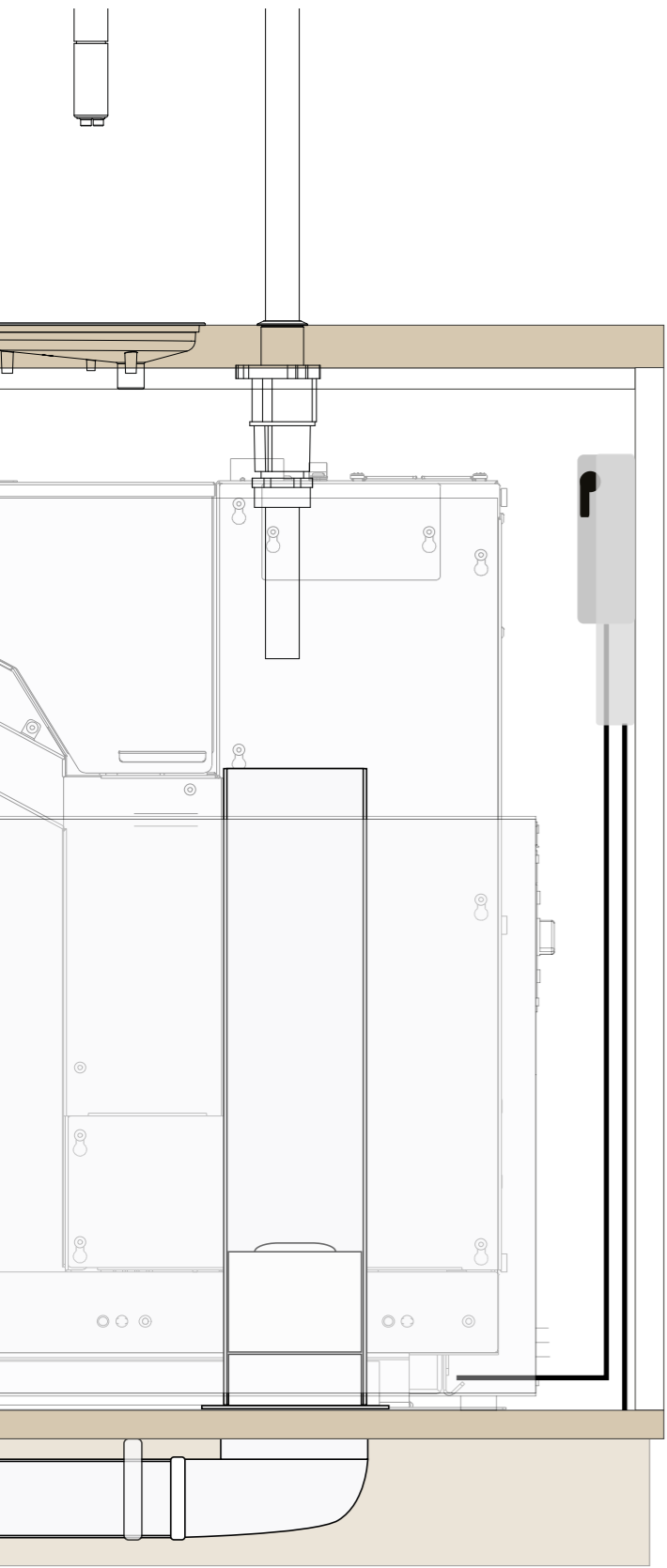

IMPORTANT
Electrical Installations
to be placed here

All electrical must be kept within boundary

Plug point
Fridge, Optional Cooler,
Ventilation & iPad Charger

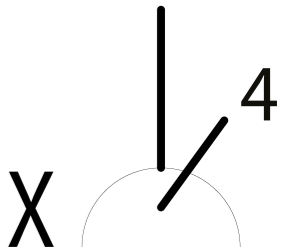

Single phase
230V, 10 amp
US & Canada:
Single phase 115V,
60 Hz, 10 Amp

Safety switch for machine main power

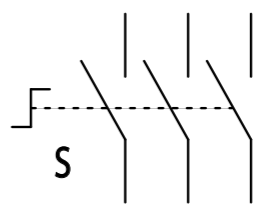

3 phase, 400V
10-16 amp

OR

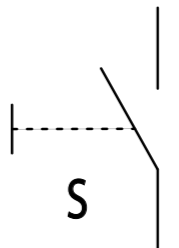

Single phase, 230V
10 or 30 amp

PLUMBING

VVS

KLEMPNERARBEITEN

水暖

scanomat

coffee solutions for more than 50 years

For more information & questions to your installation,
contact us on the below channels

Tecnical / Architect Support

E-mail: support@scanomat.dk

Chat: www.scanomat.com

International: +454918180

Denmark: +4549181212

Sweden: +46 (0)774 41 0000

Norway: +47 22662210

UK: architect@scanomat.co.uk

Locate Dealer: scanomat.com/services/partners



For TopBrewer Pro
Version: 4.0
01-01-2020