

PRE INSTALLATION GUIDE

FÖRINSTALLATIONSGUIDE

ANLEITUNG VOR DER INSTALLATION

預安裝指南

FOR

TopBrewer
Compact



Scanomat
Download Center



Scanomat
Connection Diagram



Scanomat
Architect Pack
(2D/3D Files)

For TopBrewer Pro
Version: 4.0
01-01-2020

CONTENTS

- » Introduction 3
- » Product Matrix: Choose your setup 4
- » Products Overview 5
- » Space requirements: Basic Installation 6
- » Space requirements: Extended Installation 7

CARPENTER & VENTILATION 8

- » **Basic Installations**
- » Example 1 - Pro Fridge A2 9
- » Example 2 (- Pro Fridge A3 10
- » Example 3 - Duct rediverted 11
- » **Extended / Special Installations**
- » Example 1 - with cold water 12
- » Example 2 - behind a wall 13
- » Example 3 - very tight spaces 14
- » Faucet and Drip tray 15
- » Topmounted iPad holder 16
- » Boxit Alu iPad Holder 17
- » Drip trays 18

ELECTRICAL 19

- » Electrical Requirements 20

PLUMBING 21

- » Plumbing - adjacent cabinet 22
- » Plumbing - same cabinet 23

Introduction

The operation of a TopBrewer Compact coffee system.

The TopBrewer Pro consists of a main unit, the coffee machine, the "swan neck" or tap that is installed through the tabletop and is height adjustable through the mounting bracket, a drained drip tray and a ventilation kit for the toe kick base. Additionally we offer optional accessories that are installed along side of the TopBrewer. These accessories include our extensive lineup of fridges, coolers and racks (overview on next page) that expands the machines capabilities to include milk, chocolate and ice water.

The TopBrewer is connected to the cold water supply and water is heated in professional flashheaters, meaning on demand. This works by water flowing through two 2,3kW aluminum coils when a drinks is ordered and a separate steam-coil producing steam for milk. The total heating capacity of the TopBrewer is thus 6,9 kW and it should be preferably connected to 400V, 3 phase, 16 amp (3-phase version) or 208-240V, single phase, 30 amp (single phase version) for the machine to perform to it's full potential. If only 208-240V, single phase, 10 amps is available, the machine can be re-programmed to run on a priority heating diverting power to the heating source needing it the most.

When ordering a milk drink, milk is pumped from the fridge (the pump is placed inside the fridge for sanitary reasons), and once a delivery is done the machine finishes with pushing the remaining milk out with cold water and thus cleaning the entire tubing. The water does not enter the cup but is afterwards ejected into the drain via the double-valve inside the fridge.

All water shall be purified using TopBrewer certified filtration. We require that the main inlet is filtered through a filter with a bypass so that the water reaches 4 dH°. A second filter with 0% bypass is used to completely remove lime/scale from the dedicated steamer inlet.

Installation, maintenance and warranty

The TopBrewer system can be installed in almost any location provided there is sufficient space for the machine as well as power, water supply and waste.

The TopBrewer must be placed with sufficient clearance so that it may slide out on its hinges. The fridge must be fitted so that the length of the tubes does not exceed 1,5 mm . It can be installed in an adjacent cabinet provided it maintains such maximum length. Accessories such as the Scanomat Cooler 45 and the Chocolate rack must also stay within the same maximum distances to ensure proper dispense quality.

All equipment must be fitted so that they receive proper ventilation, with temperatures not exceeding 35°C, as this would harm components and void warranty.



Product Matrix

Choose your setup



Cabinet Layout

Configuration Choices

	LESS THAN 590 MM DEPTH	ALLOWS FOR MORE THAN 590 MM DEPTH	HIDDEN OR BEHIND THE WALL
WITH WATER	PAGE 12	PAGE 12	PAGE 13
WITHOUT WATER	PAGE 10	PAGE 9	PAGE 13
COFFEE ONLY	PAGE 14		

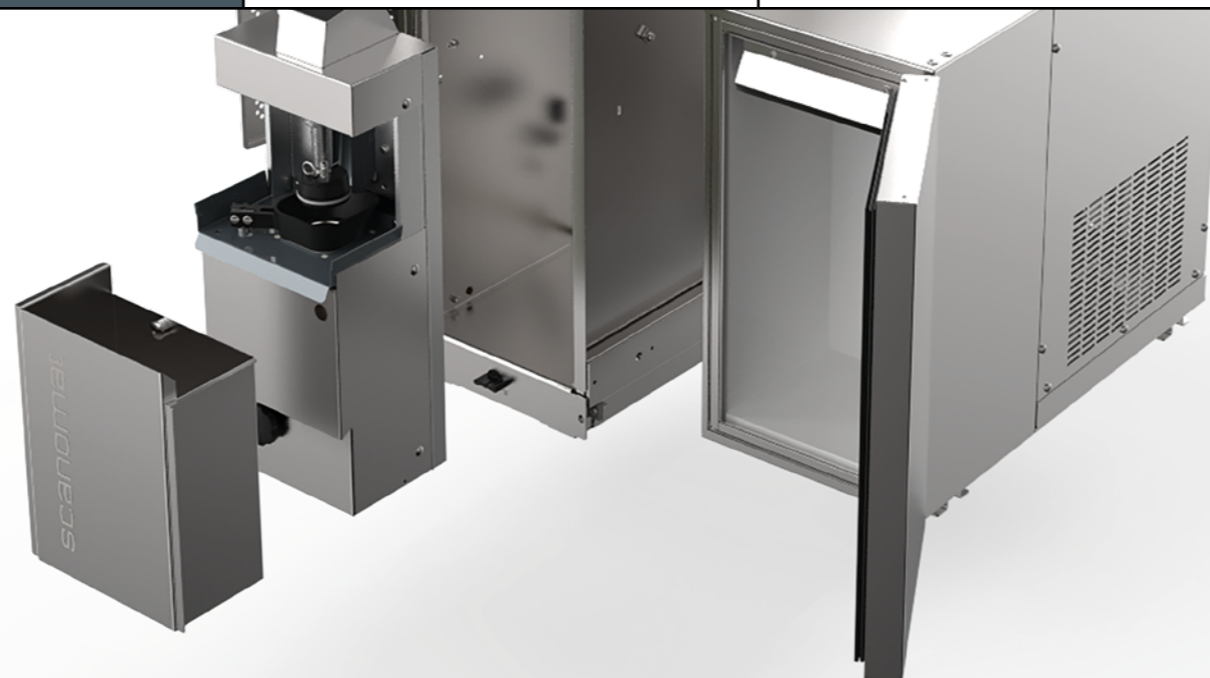





Installation Requirements

Video
Installation Walkthrough

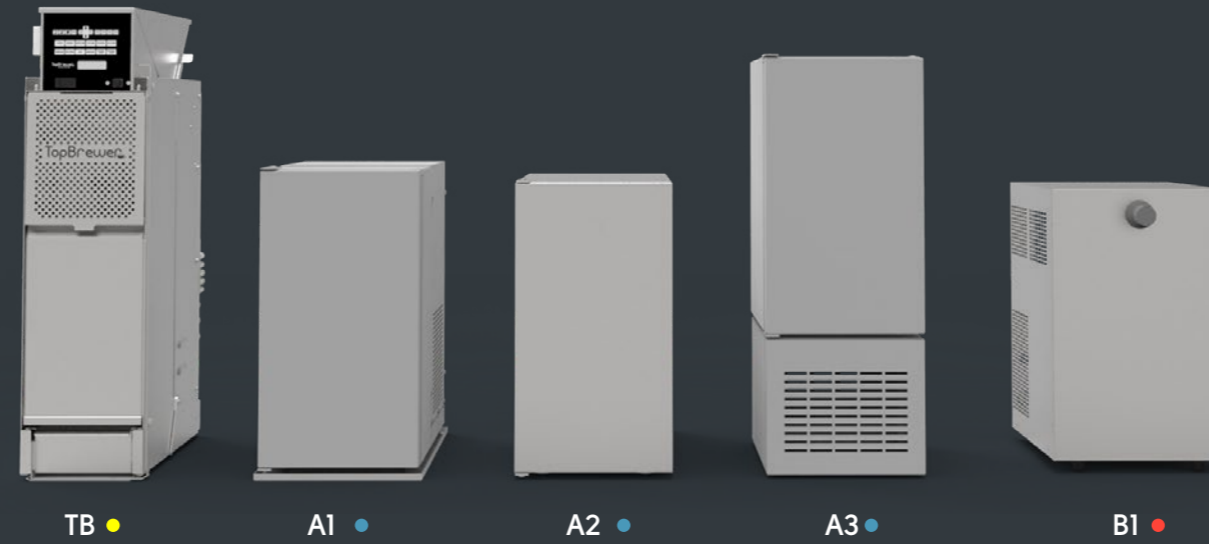

- Machine
- Fridges
- Water coolers



UNIT DETAILS	TopBrewer Compact	ICE-Bank (A1)*	Pro-fridge (A2)	Pro-fridge Tall (A3)	Cooler 45 (B1)*
Installation Dimensions (WxDxH)	183 x 510 x 670 mm	236 x 569 x 428.5 mm	231 x 600 x 430 mm	231 x 438 x 600 mm	255 x 486 x 404 mm
Packing Dimensions (WxDxH)	300 x 630 x 780 mm	246 x 579 x 488.5 mm	300 x 615 x 490 mm	241 x 443 x 660 mm	265 x 483 x 464 mm
Weight, gross.	41 kg	25 kg	20 kg	20 kg	22 kg
Weight, net.	39 kg	22 kg	17 kg	17 kg	19 kg
Bean/Cartron Capacity	1.5 kg	Up to 4 l.	Up to 8 l.	Up to 8 l.	-
Throughput/hour	120 cups	25 L	-	-	45L
Approvals	CE, ETL/UL, CB, NSF	CE	CE, ETL/UL	CE, ETL/UL	CE, ETL/UL, NSF
Power	EU	220-240V AC Full Power: 20 amp, ~ 4,6kW Priority heating: 10 amp, ~ 2,3 kW	220-240V AC, 10 amp plugpoint, for each unit 		
	UK	220-240V AC Full Power: 20 amp, ~ 4,6kW Priority heating: 10 amp, ~ 2,3 kW	220-240V AC, 10 amp plugpoint, for each unit 		
	US	208V AC Full Power: 20 amp, ~ 4,1 kW Priority heating: 10 amp, ~ 2,1 kW	115V AC, 10 amp plugpoint, for each unit 		
Water	Direct Water Connection, 3/4" type shutoff valve Water pressure: 200kPa (2 Bar) - 600 kPa (6 Bar)	-	-	-	Direct Water Connection, 3/4" type shutoff valve Water pressure: 200kPa (2 Bar) - 600 kPa (6 Bar)
Filtration	TopBrewer water filters fitted in a location adjacent to the TopBrewer. See plumbing section. Dedicated steam filter required (Pure 50, 0% bypass)	TopBrewer ActiveCoal 10.000, optional, purifies the water with active coal	-	-	TopBrewer ActiveCoal 10.000, optional, purifies the water with active coal
Drainage	Waste U-pipe, ø40mm. Manifold/drain plug (included, see Plumbing section) is inserted and components are connected here.				
Ventilation	Duct Fan Ventilation required. Cooler produces a lot of heat, which needs to be able to exit as per installation instructions in Carpenter section				

Space requirements

Basic Installation

CLEARANCE HEIGHT NEEDED FOR INSTALLATION OF SWAN NECK MIN 500 MM

A 600 MM CABINET RECOMMENDED

MIN. TOTAL WIDTH 540 MM

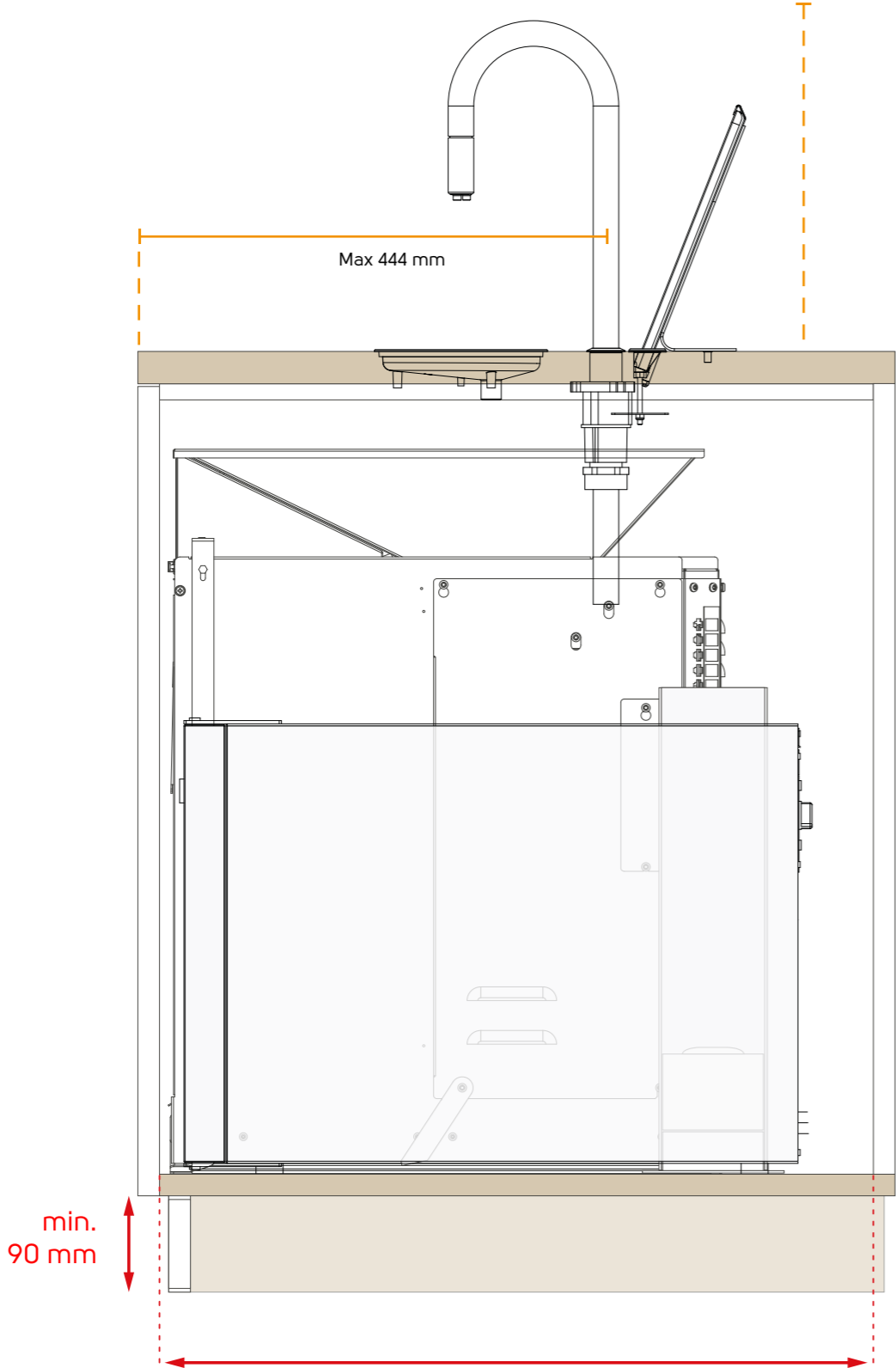

Recommended depth 600 mm
Minimum 570 mm

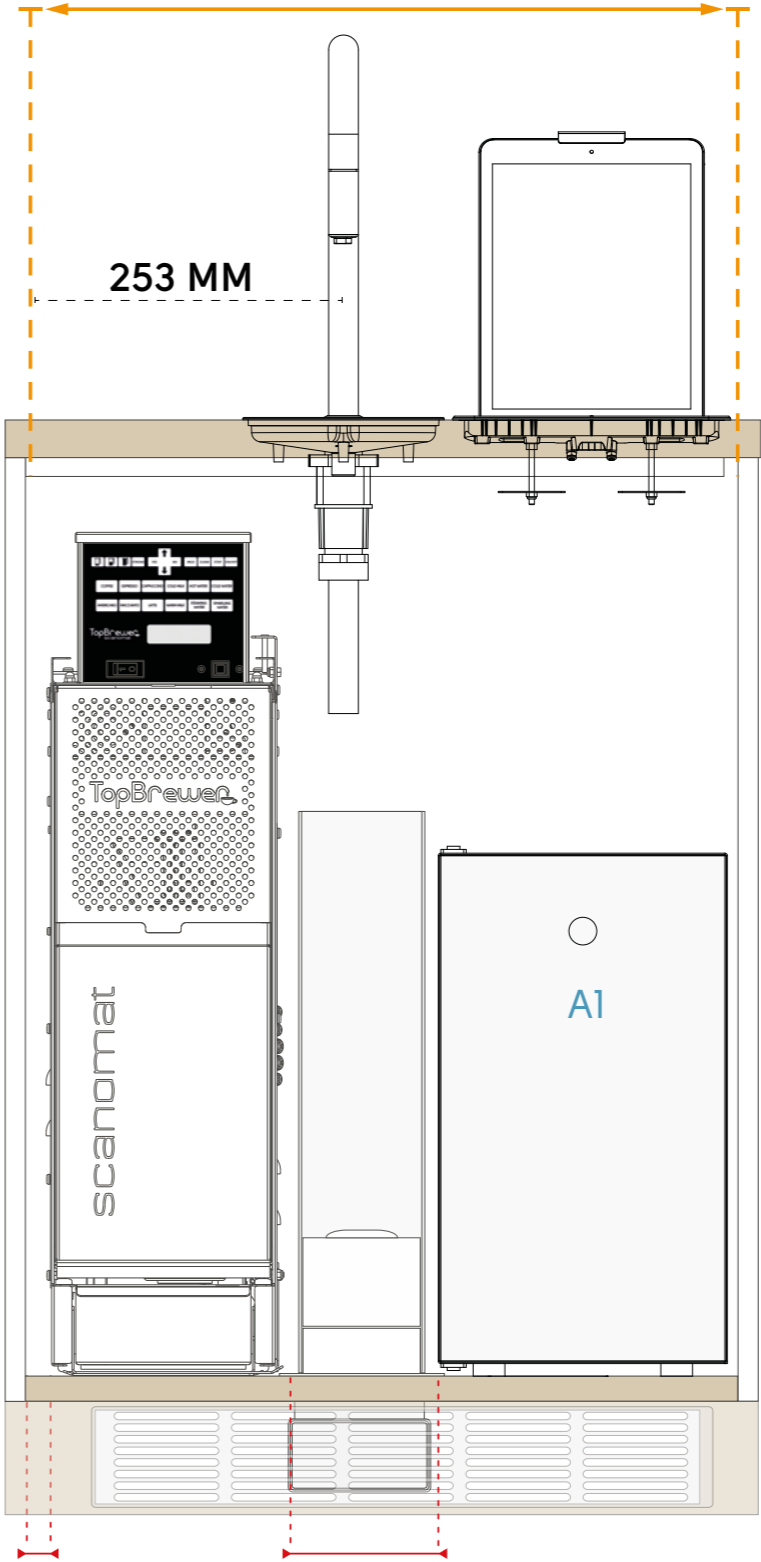

750 MM RECOMMENDED
680 MM MINIMUM

Always allow min. 40 mm clearance

Always allow min. 100 mm clearance

Space requirements

Extended Installation

CLEARANCE HEIGHT NEEDED FOR INSTALLATION OF SWAN NECK
MIN 500 MM

Max 444 mm

min.
90 mm

A1 : 569 mm
A2: 600 mm
A3: 534 mm
A4: 560 mm

A 600 MM CABINET RECOMMENDED
MIN. TOTAL WIDTH 540 MM

450 MM RECOMMENDED
MIN. TOTAL WIDTH 400 MM

253 MM

700 MM

Always allow
min. 40 mm
clearance

Always allow
min. 60 mm
clearance

Always allow
min. 40 mm
clearance

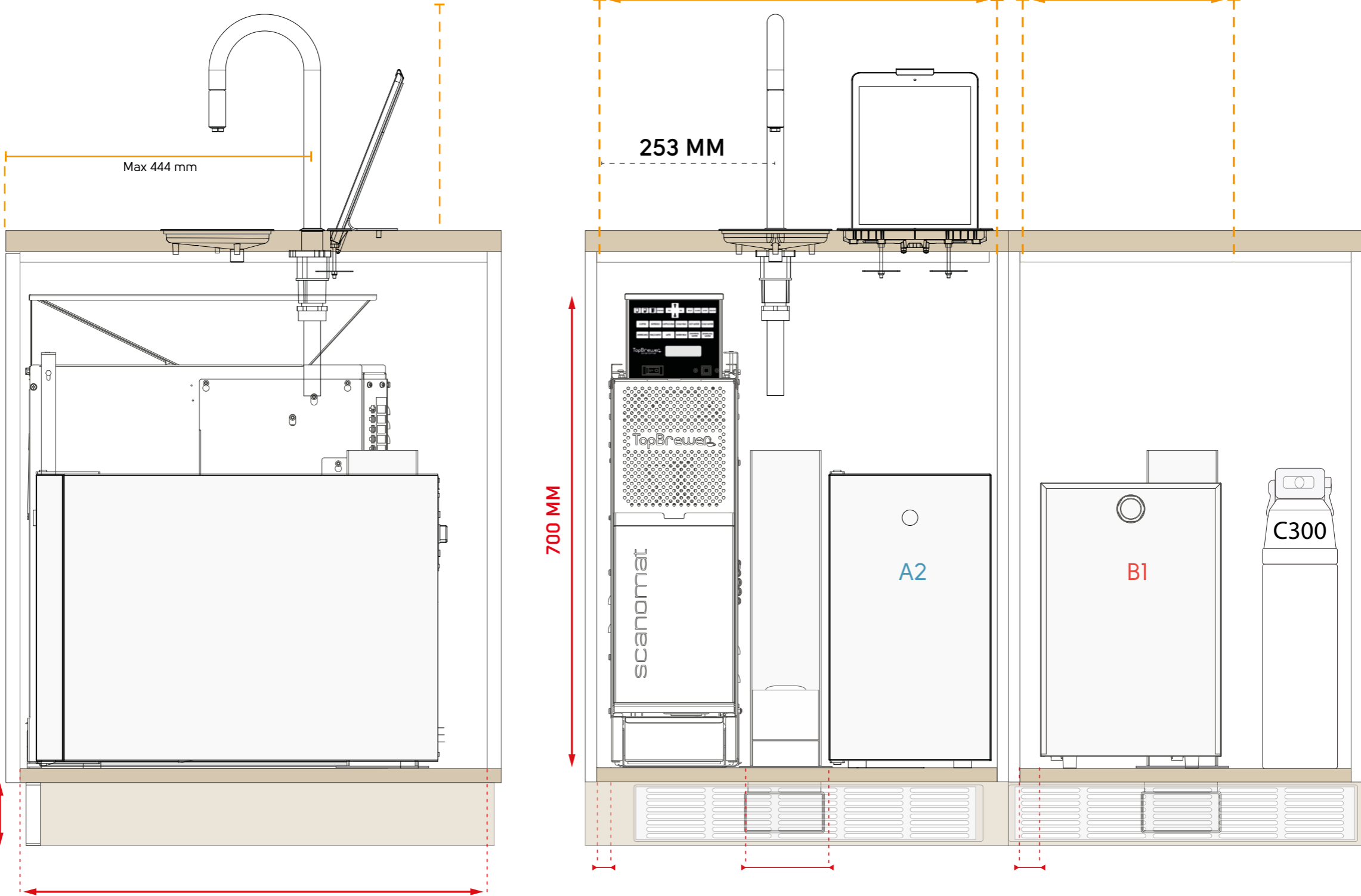

CARPENTER

SNICKARE

ZIMMERMANN

木匠

BOXIT (Table Mount or Wall-Mount options)

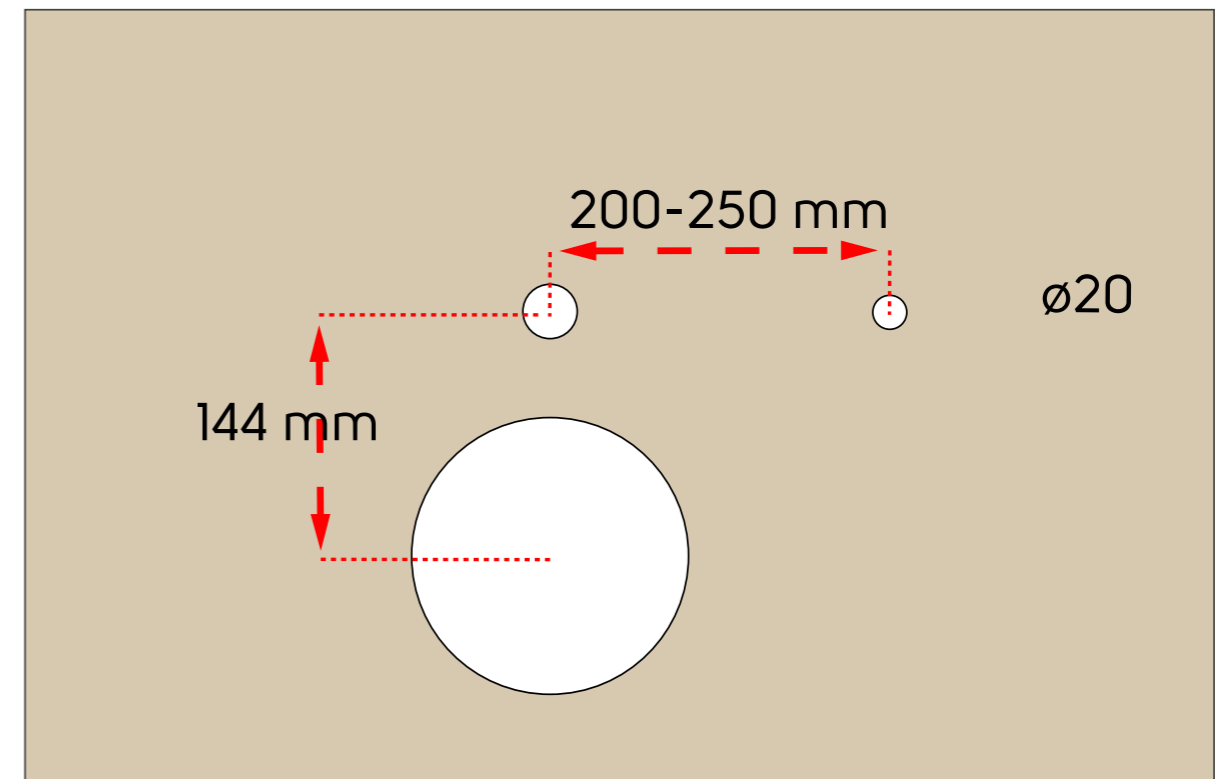
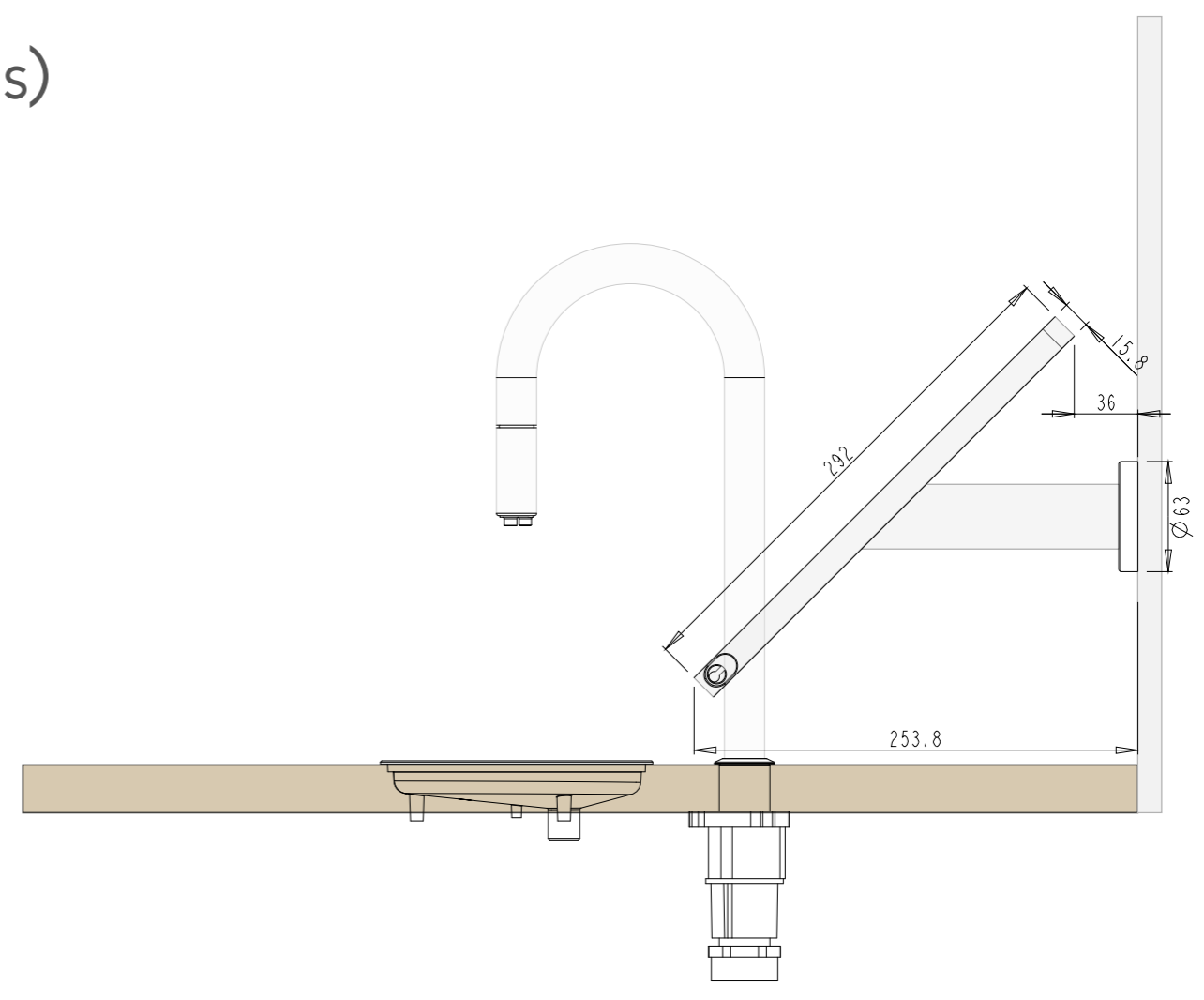
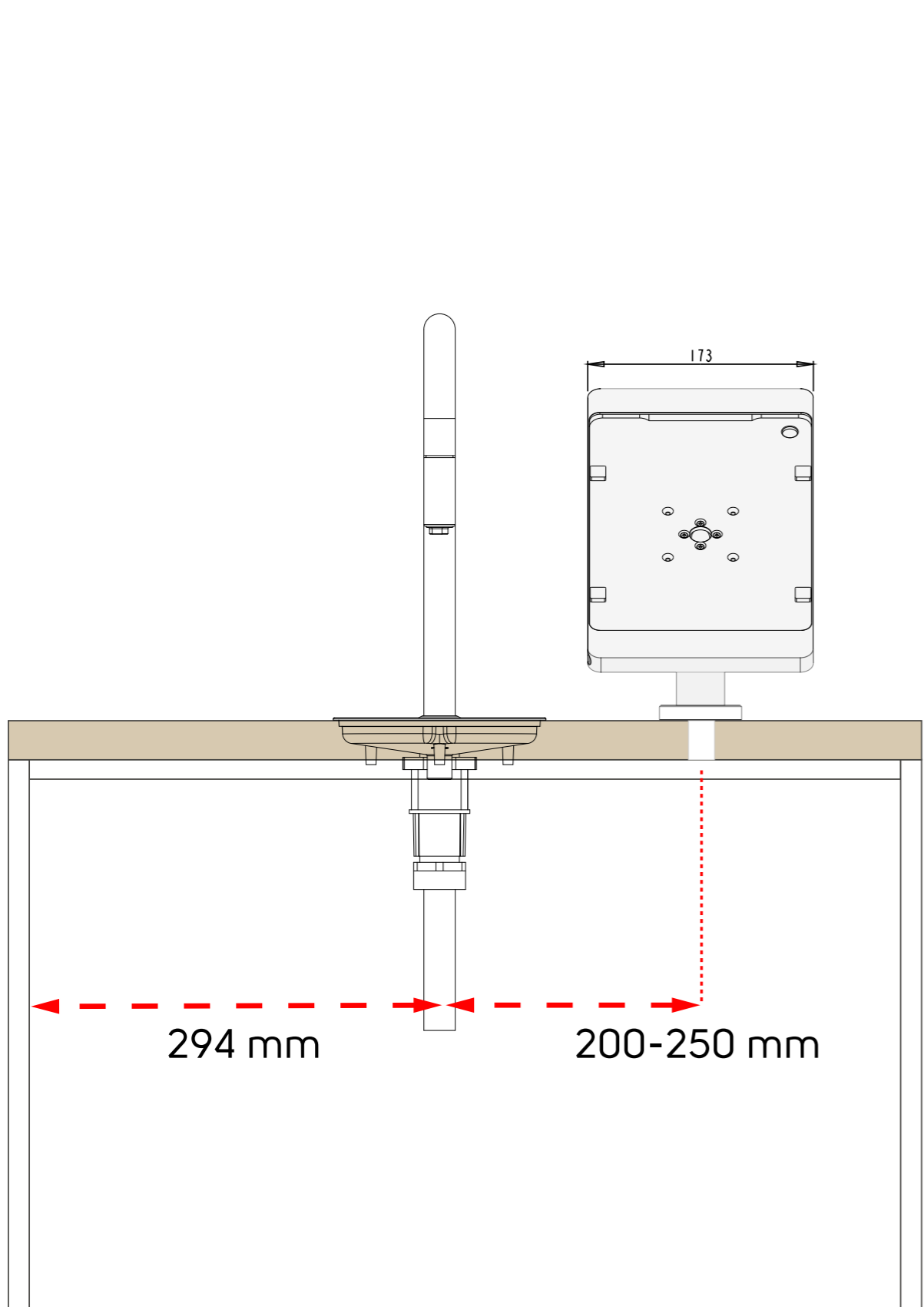

Cut out sheet - Swan neck + Driptray

NOTE that this driptray is best used for water resistant tabletops such as Granite, Marble or Corian. If wood, make sure pores are completely sealed.

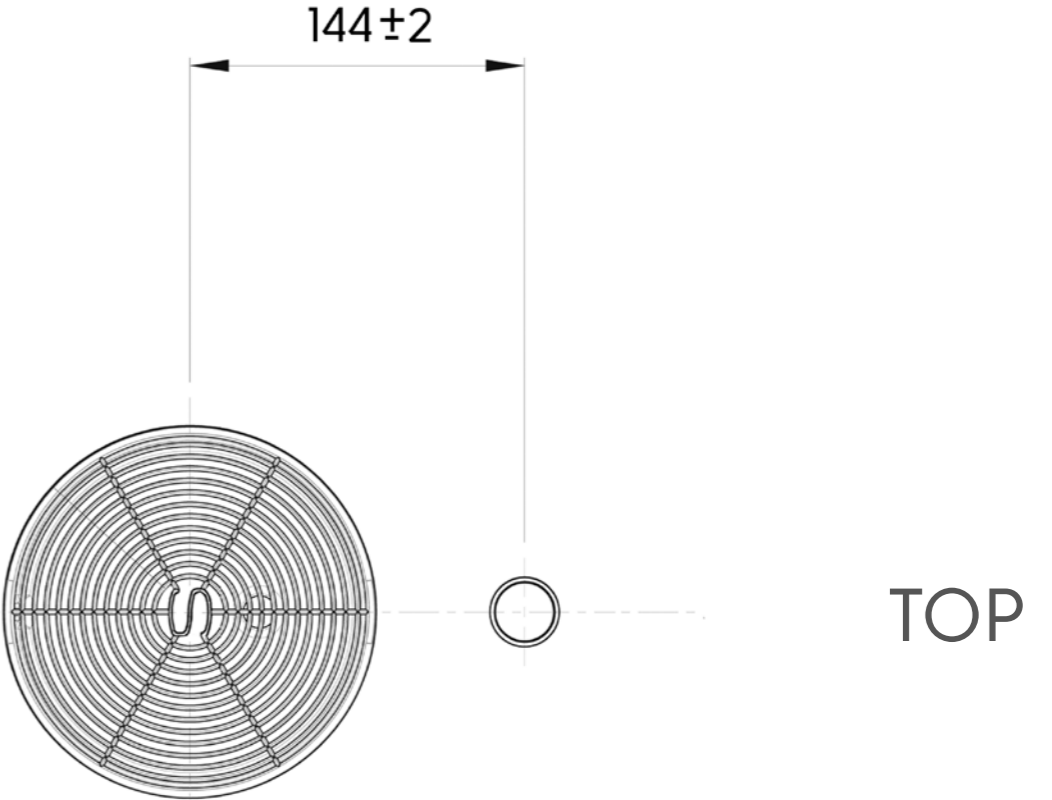
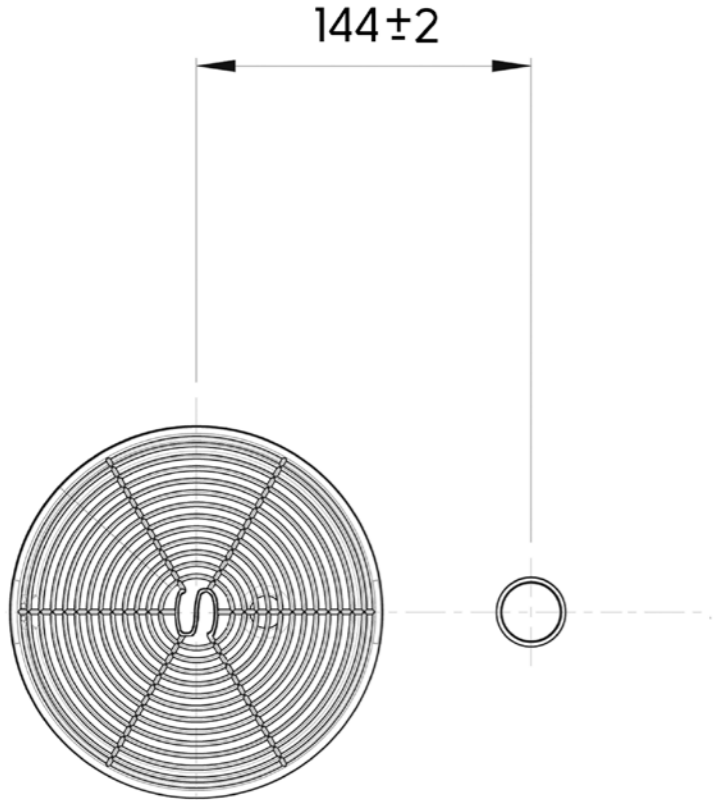
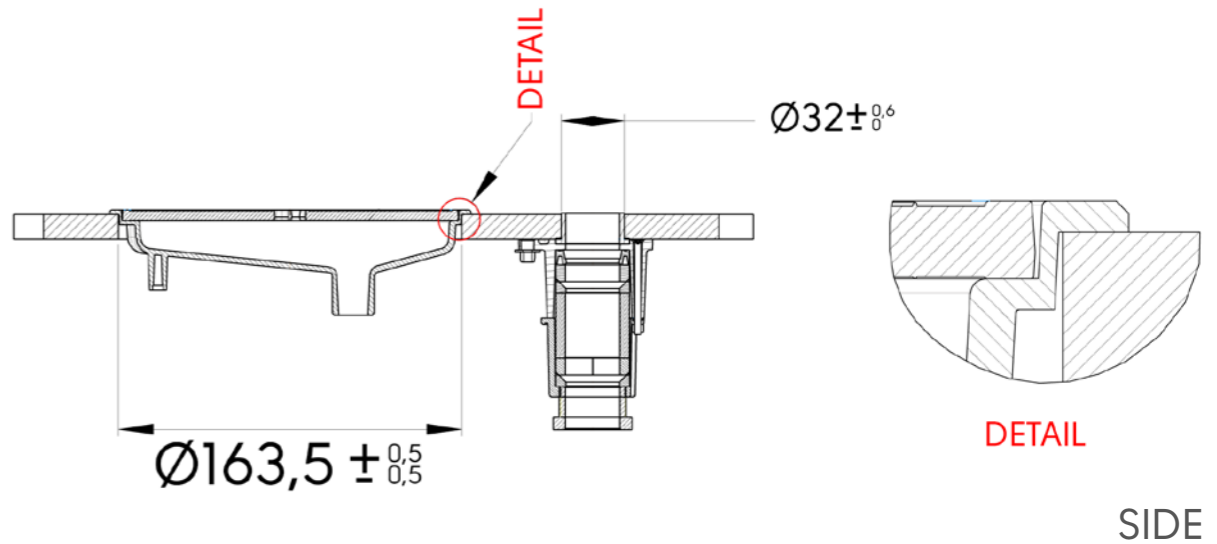
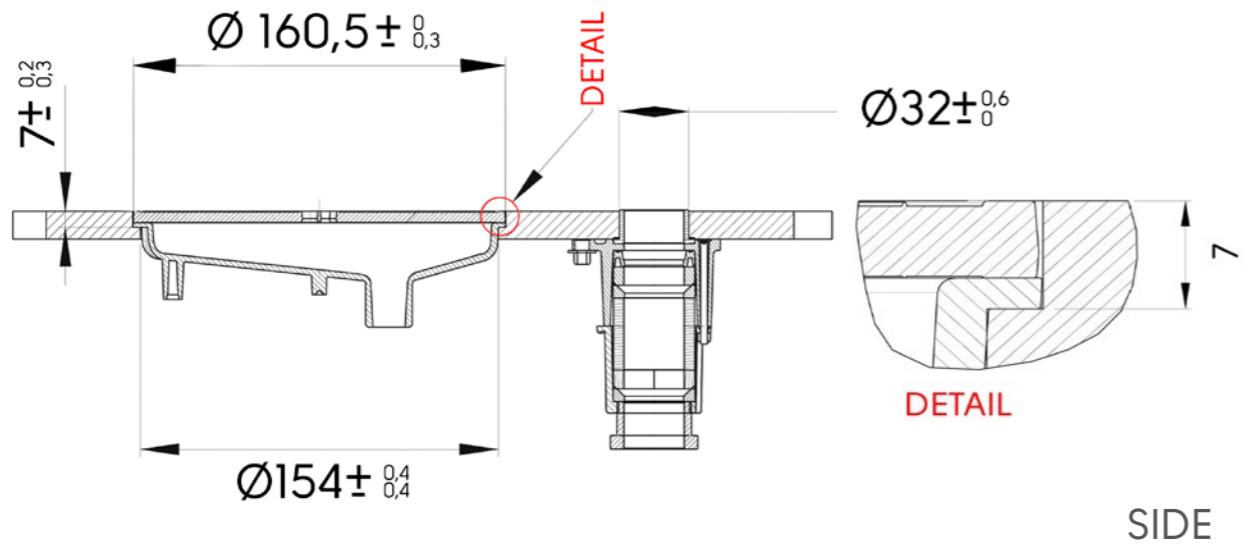

Flush mounted
 - Countersunk -
 Driptray 2006162 **1**

Top mounted
 - With Lip -
 Driptray 2006162_A **2**

ELECTRIC

ELEKTRISK

ELEKTRISCH

電的

PLUMBING

VVS

KLEMPNERARBEITEN

水暖

